

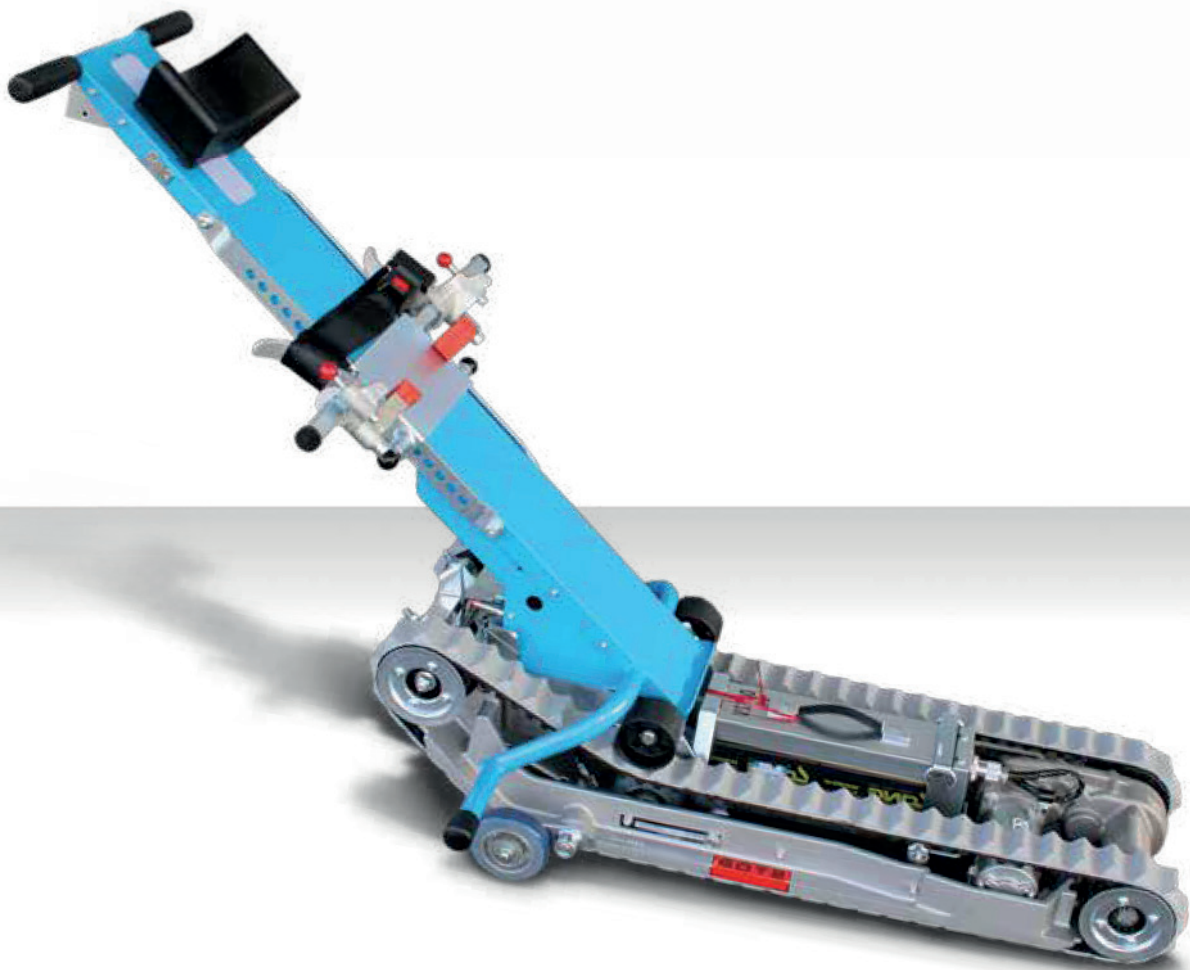

**M. BARTELS**  
REHA IM- & EXPORT GMBH

# Operation Manual Stairclimber SA-2



**FE-18-1**

# INTRODUCTION

Thank you for purchasing STAIRMATE, BARTELS POWERED STAIR CLIMBER. This manual describes proper operating procedure, inspection and maintenance. Before running the machine, be sure to read this manual thoroughly. Please keep this manual in the same, easily accessible place.

Ensure that the STAIRMATE SA-S is operated by properly skilled and experienced person only! Never leave stair climber and passengers – except in emergency cases – alone on stairs.

All machines are referred to by their serial numbers. Whenever you inquire about a machine, be sure to inform us of its serial number.

The serial number is inscribed on the side of the machine. Please record its number and year, month and date of purchase in the operation manual.

• Type, Serial number QJ SA-2	• Powered stair climber, STAIRMATE SA-2
-------------------------------	---



Please write the serial number and date purchased in the following blank space.

Serial number	
Date of Purchase	Year      Month      Day

- STAIRMATE is a powered stair climber for transferring a handicapped passenger who cannot walk up/down the stairs.  
STAIRMATE is designed to carry one passenger.  
Never carry a baby in the arms, have a child on the passenger's lap or carry any similar load while using STAIRMATE even when the total weight does not exceed the maximum load. Improper usage is dangerous. Only one passenger can use STAIRMATE while Seat Belt is fastened.
- The operator must call out to the passenger to inform him/her the next action with simple words in order to reduce passenger's anxiety before the operator moves STAIRMATE to the next phase of the procedure.  
(Pay special attention to reducing passenger anxiety before and during STAIRMATE's ascent/descent of the stairs.)

## SAFETY PRECAUTIONS

To maintain safe operation, important safety precautions, classified into Danger, Warning and Caution, are indicated in corresponding parts of the operation manual. The definition of each precaution is explained in the following section.

 <b>DANGER</b>	Neglecting this warning indication or operating the machine improperly may cause serious personal injury or even death.
 <b>WARNING</b>	Neglecting this warning indication or operating the machine improperly may seriously endanger the concerned person's health or life.
 <b>CAUTION</b>	Neglecting this warning indication or operating the machine improperly may cause injury to the concerned person or damage the machine or related items. If you transfer this machine, be sure to attach this operation

# TABLE OF CONTENTS

## TABLE OF CONTENTS

<b>1.</b>	<b>ESSENTIALS OF SAFE OPERATION</b>	<b>4</b>
<b>2.</b>	<b>CONFIGURATION AND SPECIFICATIONS</b>	<b>6</b>
2.1	PRODUCT CONFIGURATION	6
2.2	SPECIFICATIONS	6
2.3	MATERIAL	7
<b>3.</b>	<b>NAME OF EACH UNIT</b>	<b>7</b>
<b>4.</b>	<b>ASSEMBLING THE MACHINE</b>	<b>8</b>
4.1	NAME OF EACH ASSEMBLY	8
4.2	ASSEMBLY PROCEDURE	8
4.3	HEADREST ATTACHMENT	9
<b>5.</b>	<b>DESCRIPTION OF EACH UNIT</b>	<b>10</b>
5.1	SWITCHES	10
5.2	BATTERY PACK REMOVAL AND REINSTALLATION	11
5.3	STAIR GAUGE HANDLING PROCEDURE	12
<b>6.</b>	<b>BATTERY CHARGE SYSTEM</b>	<b>13</b>
6.1	BATTERY	13
6.2	CHARGER	13
6.3	CHARGING PROCEDURE	14
6.4	MALFUNCTION, INSPECTION, RESOLUTION PROCEDURE	16
6.5	BATTERY REPLACEMENT	17
<b>7.</b>	<b>PRE-USE INSPECTION</b>	<b>18</b>
<b>8.</b>	<b>OPERATION</b>	<b>22</b>
8.1	WHEELCHAIR SETTING	22
8.2	ASCENDING STAIRS	26
8.3	DESCENDING STAIRS	29
<b>9.</b>	<b>DAILY MAINTENANCE AND CARE</b>	<b>31</b>
9.1	BATTERY	31
9.2	RUBBER CRAWLERS	31
9.3	MISCELLANEOUS	31
<b>10.</b>	<b>TERMS OF GUARANTEE</b>	<b>31</b>
<b>11.</b>	<b>INSPECTION AND MAINTENANCE</b>	<b>32</b>
<b>12.</b>	<b>REUTILISATION</b>	<b>33</b>
<b>13.</b>	<b>AGENTS ABROAD</b>	<b>34</b>

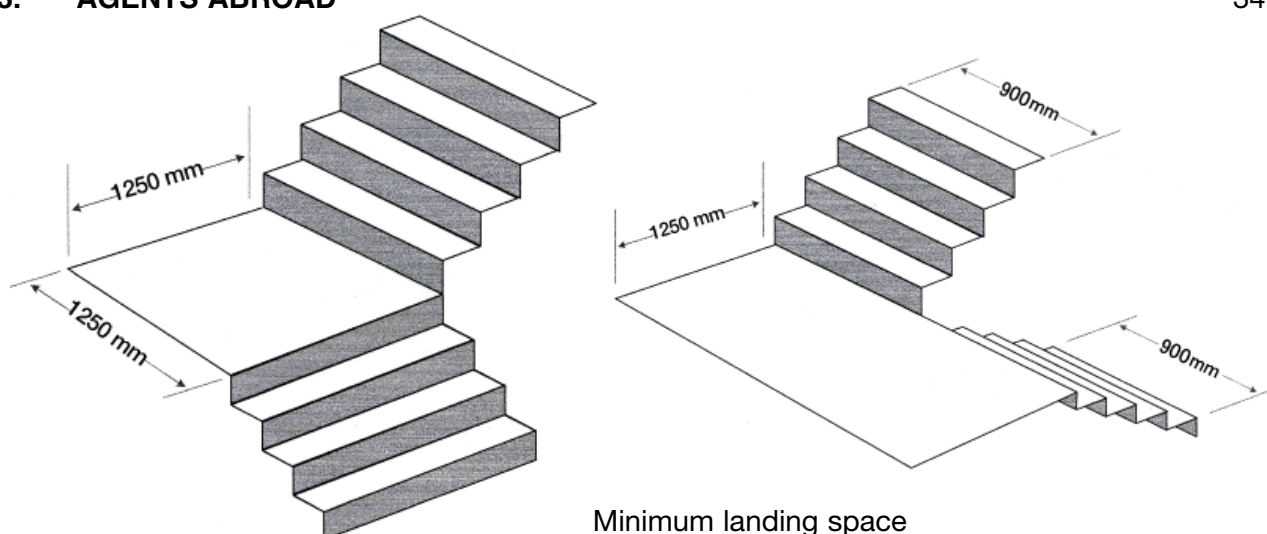

# 1. ESSENTIALS OF SAFE OPERATION

## 1. ESSENTIALS OF SAFE OPERATION

Before using STAIRMATE

STAIRMATE cannot be used on spiral staircases, curved staircases, and staircase angles exceeding 35 degrees, stairs with larger pitch or stairs with rough edges.

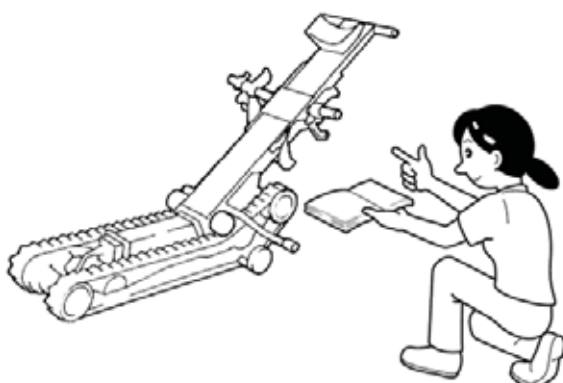
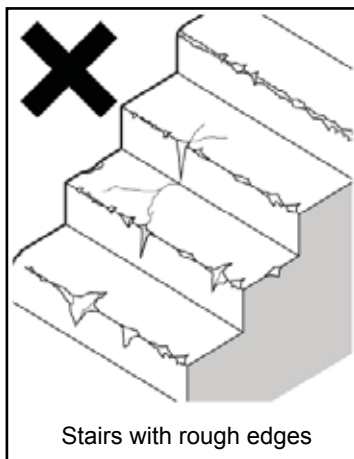
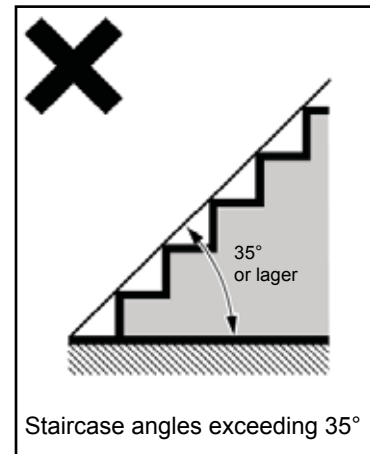
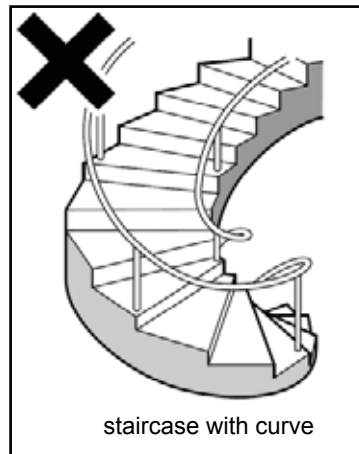
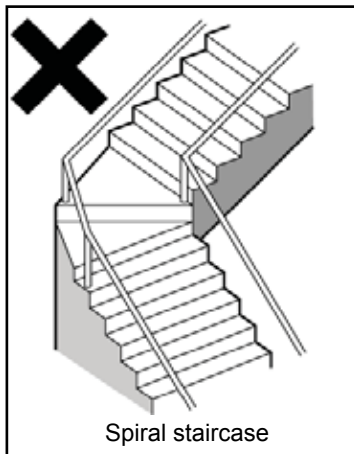

1. Always check STAIRMATE before using it:

- The operator must check STAIRMATE before using it.
- The initial inspection is necessary for safe operation.

## 2 Handling of Battery:

- Battery is a sealed type. It is unnecessary to refill it with water. Never dismantle Battery.
- Never position Battery near flame or short-circuit Battery.
- If Battery is cracked and its electrolytic solution contacts skin or clothes, immediately rinse the contaminated area with plenty of water
- If electrolytic solution splashes into the eye, rinse the eye with plenty of clean water and consult an ophthalmologist.
- Use special Battery Charger for charging Battery.



## 3 Safe operation with proper knowledge:

- The operator needs sufficient training. Be sure the training is undertaken before the operator runs this machine for the first time.
- Proper clothes, suitable to machine control, must be worn.
- The machine can be run only after Wheelchair is safely secured by Forks, Seat Belt and other necessary items.
- No operator overworked, sick, taking medicine, intoxicated, or otherwise inhibited may operate STAIRMATE.

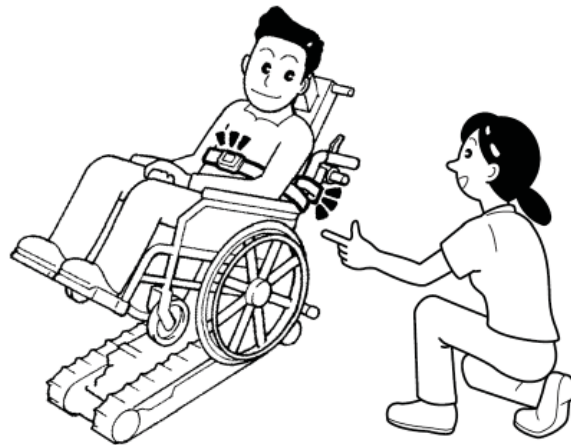

## 4 Operation on a staircase:

- Never run the machine on a staircase angle exceeding 35 degrees, on a curved staircase, an oily staircase, an icy staircase, a wet or slippery staircase or any other inappropriate staircase.
- Obliquely ascending or descending the stairs will result in danger of serious accident. The operator must avoid oblique operation on stairs. Always approach the staircase squarely.
- Whenever running the machine upward, the operator must always pay attention to the area behind him/herself. Do not run STAIRMATE if the stairs is crowded. Whenever running the machine downward, the operator must always pay attention to the front of the machine. Do not run STAIRMATE if the stairs is crowded.
- Never let go of the machine unless unavoidable circumstances separate the operator from the machine.

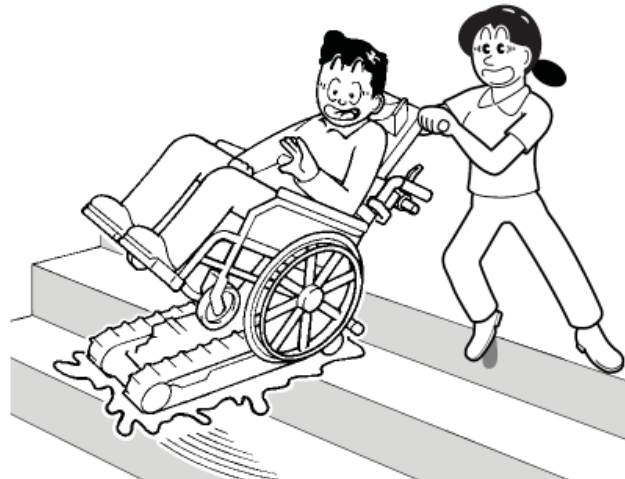

## 5 Stopping machine

- If the machine gives trouble, malfunctions or is damaged, immediately stop operating the machine. Running it with a problem existing can result in a serious accident.

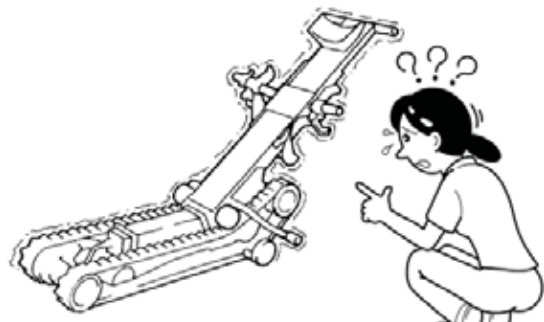

## 2. CONFIGURATION AND SPECIFICATIONS

## 2. CONFIGURATION AND SPECIFICATIONS

### 2.1 PRODUCT CONFIGURATION

STAIRMATE consists of the following assemblies.

• Handle Unit
• Drive Unit
• Wheelchair Mount Unit
• Headrest

• Drive Unit Wheels	
• Battery Pack	
Stansard accessories	• Changer (12V) 1 unit
	• Parts List 1 copy

### 2.2 SPECIFICATIONS

Model	SA-2
Passenger	1
Operator	1
Rubber Crawler	2 Rubber Crawlers (Width: 51mm)
Stair ascent speed	20 steps (6.45 m) / min.
Stair descent speed	28 steps (8.81 m) / min.
Maximum load	130 kg
Maximum stair angle	35°
Motor	Type: permanent-magnet DC motor                      Rated power: 210 W / 30 min.
Brake	Spring loaded electromagnetic brake
Running time (min) / charge	Ascending: 600 steps / 30 min.              Descending: 840 steps / 30 min.
Battery	Maintenance free type sealed lead battery 12V - 20Ah
Charger	Input: 100-240VAC, 50/60Hz, 1.0A MAX              Output: 12VDC, 3A
Weight	54 kg

#### External dimensions

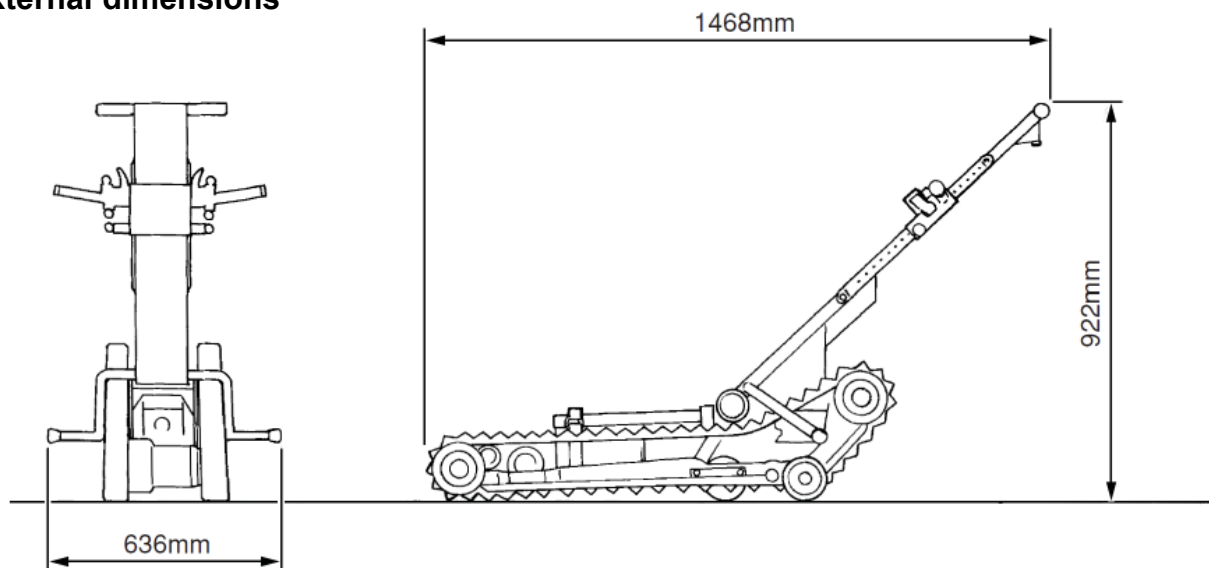



## STAIRMATE's Wheelchair-capable mount

A: Wheelchair height	760 mm up to 950 mm from the floor
B: Space under the X-frame	Center height: 210 End height: 170 mm Crawler under-frame
C: Inside width between base tubes	320 mm or wider
D: Main Wheel diameter	22 inch or larger

### The following wheelchair types cannot be mounted:

1. Reclining type wheelchair
2. Foldable or detachable handle type wheelchair
3. Detachable armrest type wheelchair
4. Caliper brake installed Wheelchair
5. Any wheelchair that has machine part trouble.

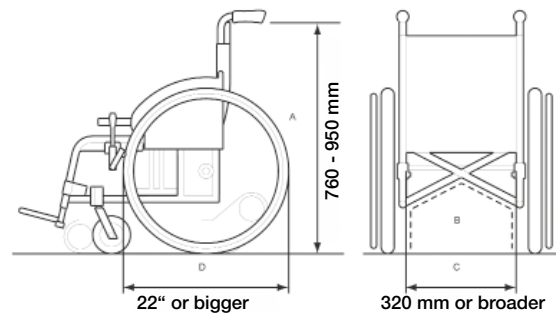

The dimensions shown above are standard values. Some wheelchairs may not fit.

## 2.3 MATERIAL

Aluminium die casting.

## 3. NAME OF EACH UNIT

## 3. NAME OF EACH UNIT

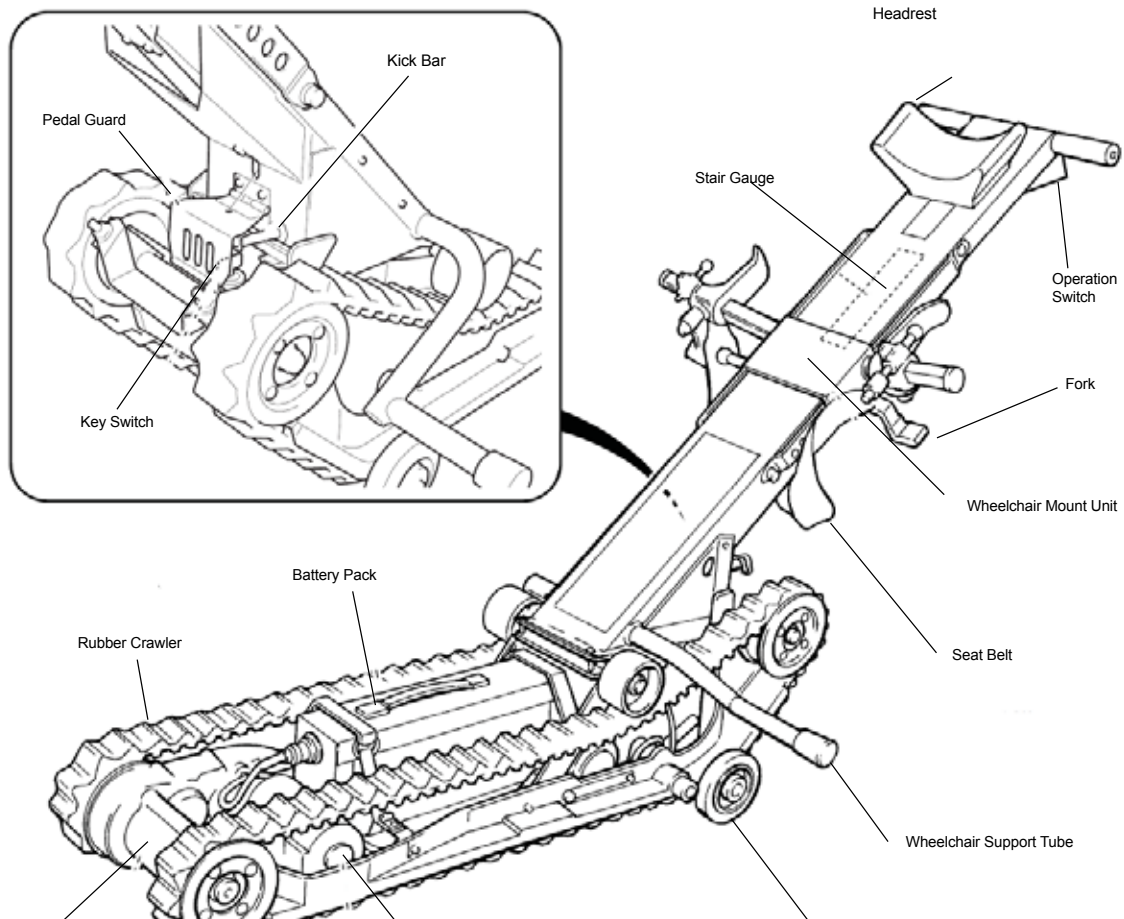

## 4. ASSEMBLING THE MACHINE

## 4. ASSEMBLING THE MACHINE

### 4.1 NAME OF EACH ASSEMBLY

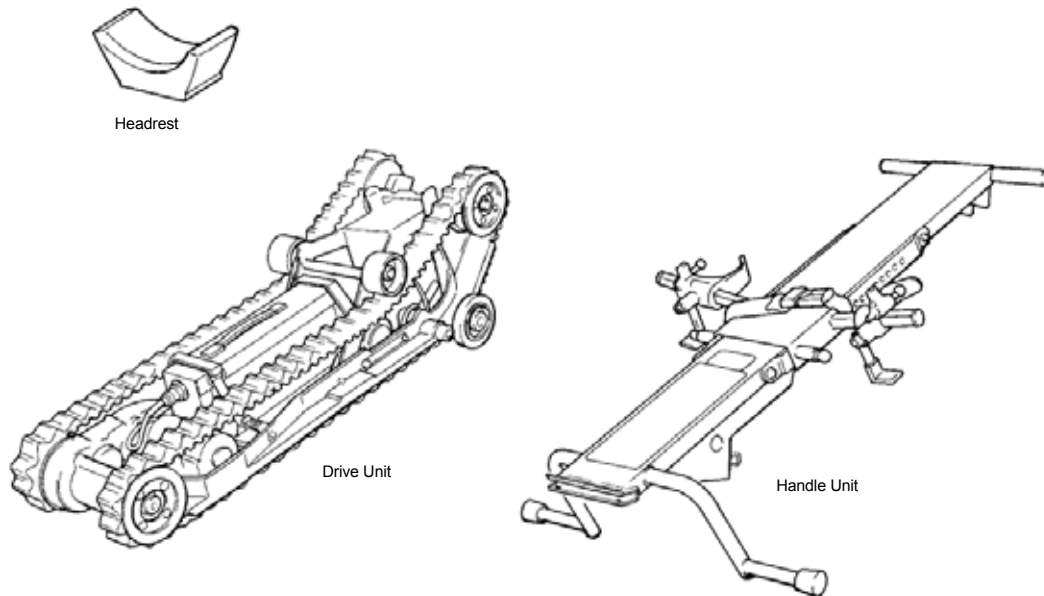

### 4.2 ASSEMBLY PROCEDURE



**CAUTION**  
**CAUTION**

- Before STAIRMATE is assembled, be sure to set Key Switch to „OFF“.
- After STAIRMATE is assembled, confirm that Lock Pin is firmly secured by its „R“ Pin to Handle's Hook Point. Insecure Lock Pin attachment can cause passenger to fall or other serious accident.

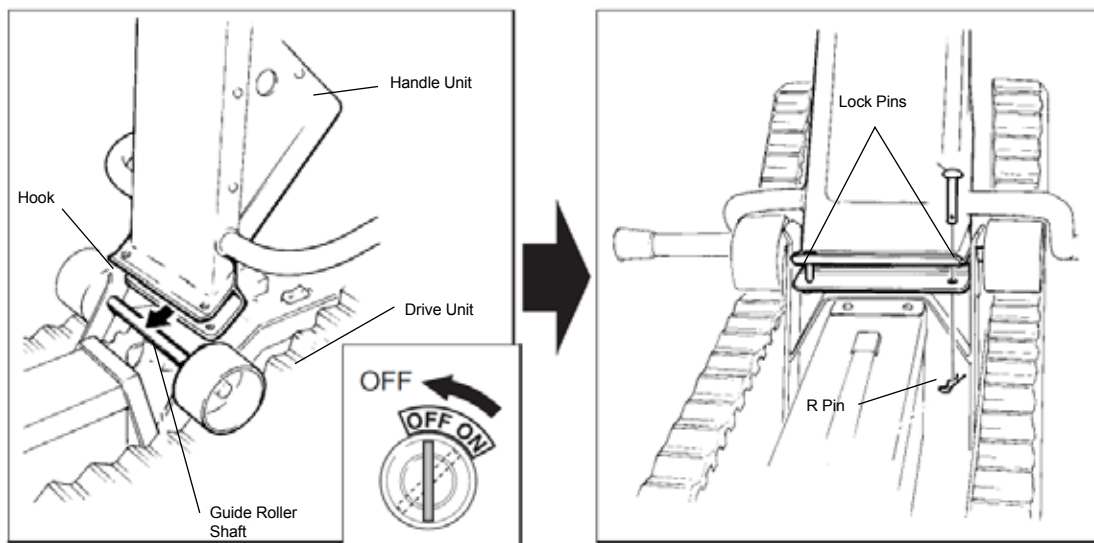

1. Confirm that Key Switch is set to „OFF“. Set Handle Unit's Hook against Guide Roller Shaft and push it until Hook reaches its dead-end against Guide Roller Shaft.
2. Insert two Lock Pins into the two sides of Handle Hook unit. Then secure each Lock Pin with its „R“ Pin.



3. Lower Handle Unit to meet Guide Plate and secure it firmly.

**NOTE:** Unless Handle Unit is fully locked, STAIRMATE will not run even when Switch is pressed UP or DOWN.

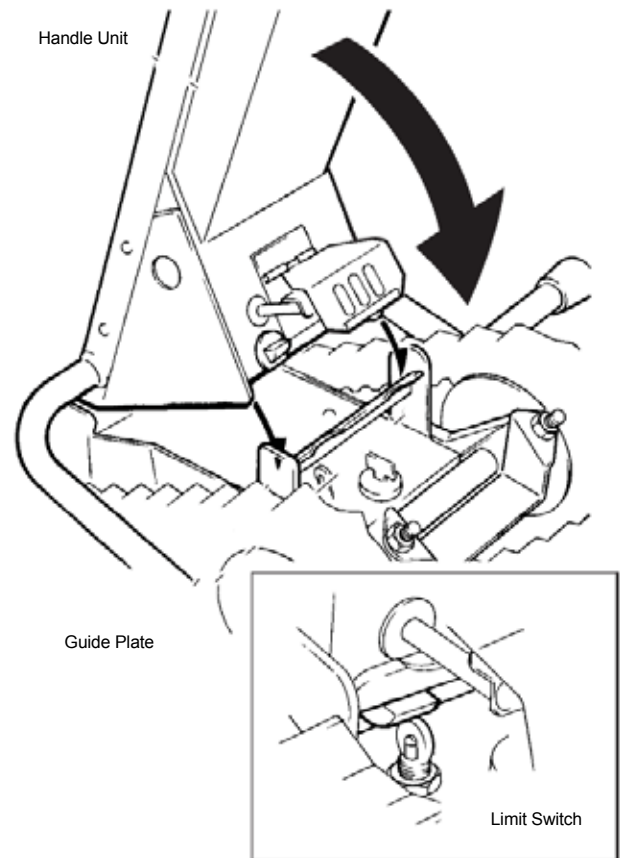

### 4.3 HEADREST ATTACHMENT

Install Headrest to Handle Unit with Velcro Tape. Velcro Tape must be firmly applied at specified height in order to support the passenger.

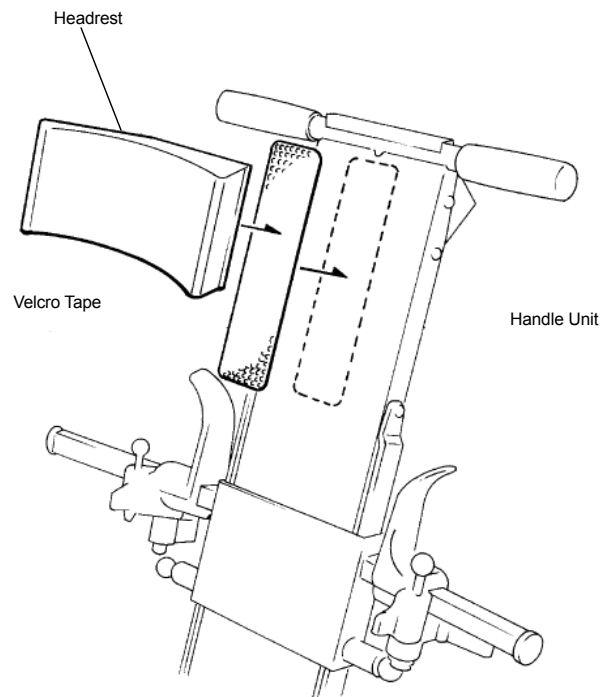

## 5. DESCRIPTION OF EACH UNIT

## 5. DESCRIPTION OF EACH UNIT

### 5.1 SWITCHES

#### 1. Key Switch

It turns on/off the power supply. When it is turned clockwise, the power will be ON and when turned counter-clockwise, the power will be off.

**NOTE:** When STAIRMATE is not to be used (to be stored, to be charged, to be transported), turn off Key Switch, remove Key and keep it in an appointed place.

#### 2. UP/DOWN Switch

Selects ascent or descent mode. Only while this Switch is pressed, does the machine run. If UP Seesaw is pressed, the machine will ascend. If DOWN Seesaw is pressed, the machine will descend. When the finger is released, Switch will automatically return its neutral position and the machine will stop.

#### 3. Emergency Stop Switch

When this Switch is pressed, the machine will stop immediately. STAIRMATE won't restart. Even when the other Switch is pressed. To release the emergency stop condition, turn Emergency Stop Switch in the „arrow“ indicated direction.

#### 4. Operation Switch on Drive Unit

When Forward or Reverse Switch top is pressed, the machine will run in the corresponding direction. When Switch is released, Switch will return its neutral position and the machine will stop.

**NOTE:** This Switch is not to be used for stair work. Use it only for running STAIRMATE without Handle Unit.

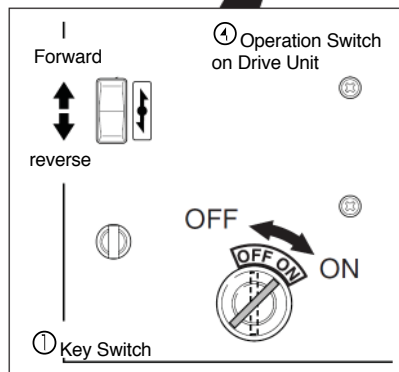
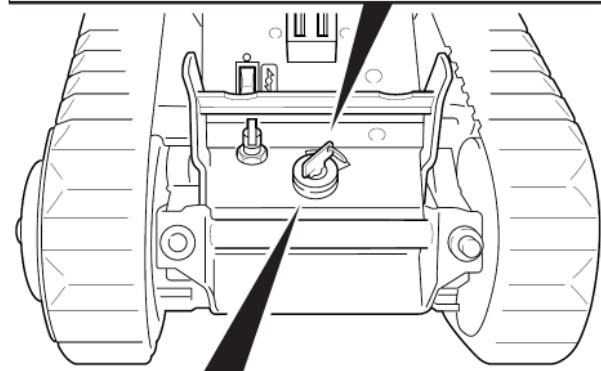
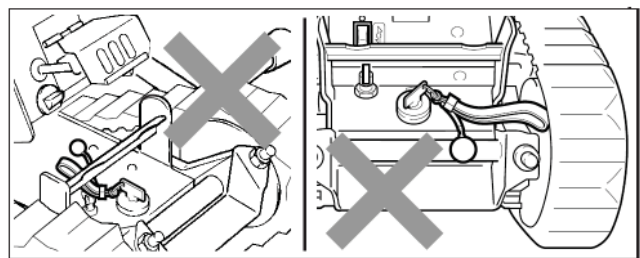
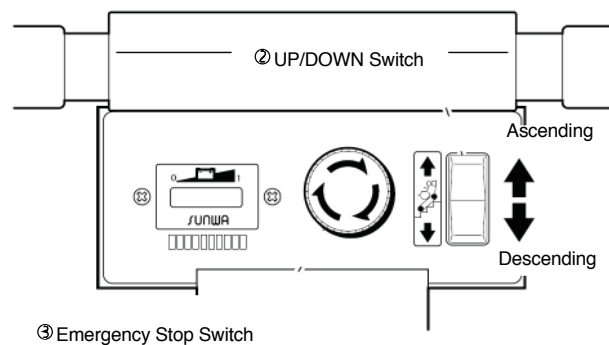

**DANGER**

Never attach the objects to Key. If any object is attached to Key, it will be caught in Lock Unit preventing Frame from locking. This could result in a serious accident



**CAUTION**

- If Key Switch is kept in the ON position, Battery will more quickly discharge. When the machine is not to be in use, be sure to turn off Key Switch and remove it.
- Never attach the objects to Key. Doing so may cause the objects to be caught by Rubber Crawler.
- Pay attention that the operator's fingers are not caught in a Rubber Crawler while the operator pushes Operation Switch on Drive Unit near floor level.

## 5.2 BATTERY PACK REMOVAL AND REINSTALLATION

1. Unscrew Battery Plug's Screw and then release Plug from Battery Pack's Receptacle. Never disconnect Plug by pulling Cord. Be sure to hold Battery Plug itself to remove it.

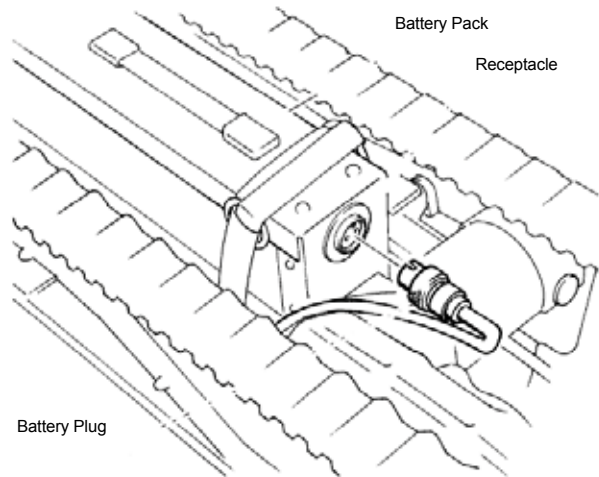

2. Pull and remove Battery Securing Handle from Battery Pack.

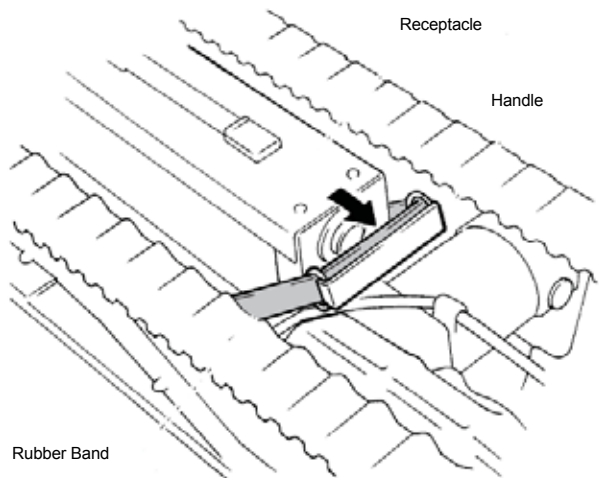

3. Hold Battery Pack's Handle and remove it while pulling it obliquely to front and upward. Battery Pack reinstallation is the reverse of Battery Pack removal.

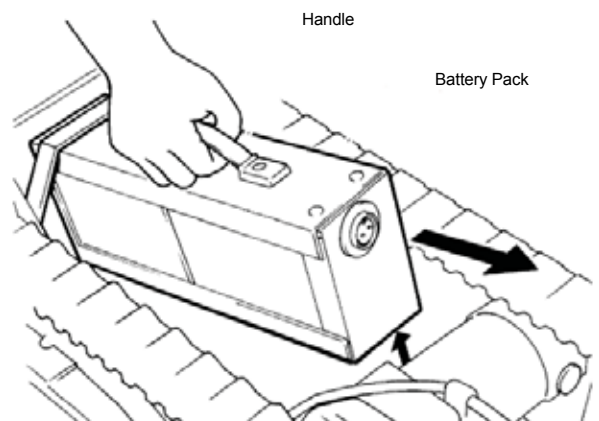

### CAUTION

- When Battery Pack is installed, be sure to tighten Plug's Screw.
- If Battery Pack is dropped, Battery may be damaged. Pay attention to safe handling during Battery removal/reinstallation.

## 5.3 STAIR GAUGE HANDLING PROCEDURE

1. Detach Stair Gauge from the rear of Handle Unit.

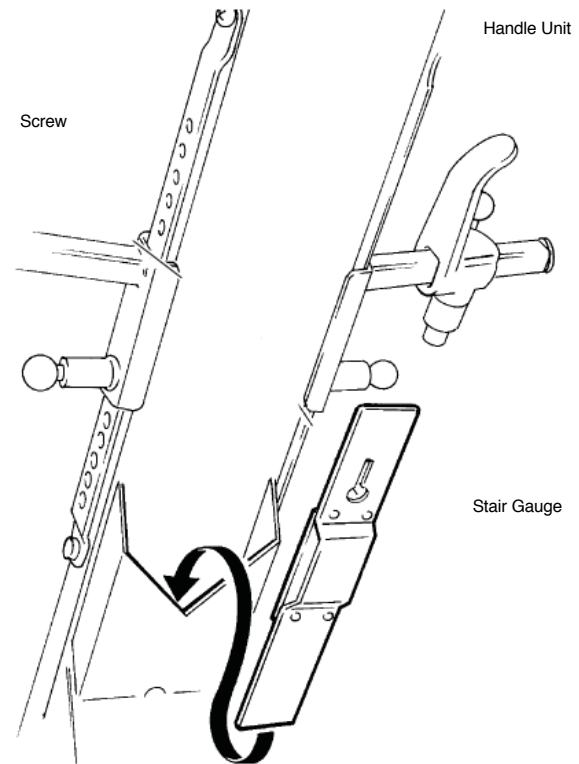

2. Set Stair Gauge against the edge of the neighboring stair. Observe Pointer position. If Pointer settles within Green Color Range, it is possible to use STAIRMATE.

Never use STAIRMATE on a stair if Pointer settles within Red Color Range. After the measurement is completed, be sure to return Stair Gauge to its original position on STAIRMATE.

**NOTE:** If the customer loses Stair Gauge, they must immediately order a replacement from the agency where purchased.

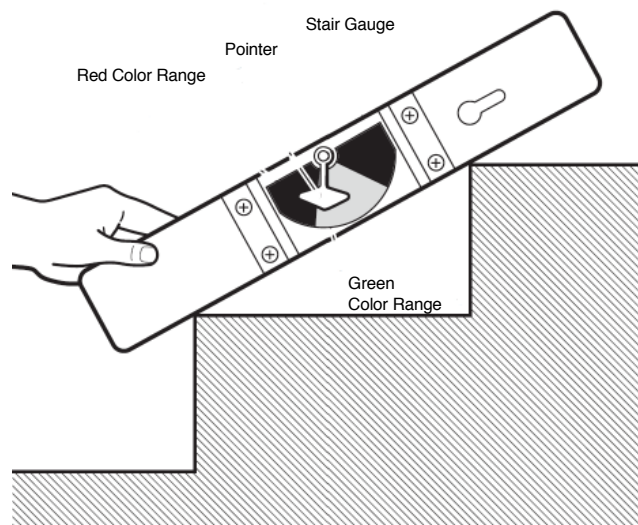

**DANGER**



Never use STAIRMATE on stair if Stair Gauge's Pointer settles within Red Color Range.(over 35 degrees)

## 6. BATTERY CHARGE SYSTEM

### 6.1 BATTERY

A Sealed Lead Battery is used in STAIRMATE. It is a maintenance-free and non water requiring Battery. Whenever Battery is handled, be sure to follow the cautions shown below.

**NOTE:** Immediately after Battery is used, Battery must be charged using special Battery Charger. If insufficient battery charge is left, less power for following operations will result in difficulty of operation. Or if Battery is left depleted for a long period of time, it may be damaged.

 <b>DANGER</b>	<ul style="list-style-type: none"><li>• Never bring Battery near a flame.</li><li>• Never disassemble Battery.</li><li>• Never connect Battery Terminals with tools or metals.</li></ul>
 <b>WARNING</b>	<ul style="list-style-type: none"><li>• Use special Battery Charger for charging Battery.</li><li>• Always check Battery's condition. If any crack or deformation or water leakage is observed, replace with a new one.</li><li>• Clean and wipe Battery with a cool or warm water moistened cloth. Never wipe with gasoline, thinner, organic solvent or oil moistened cloth.</li><li>• If the electrolytic liquid from a damaged Battery contacts skin or clothes, rinse the area with plenty of water immediately. If the electrolytic liquid invades the operator's eye, rinse it with clean water immediately and consult an ophthalmologist.</li></ul>
 <b>CAUTION</b>	<ul style="list-style-type: none"><li>• Battery is a sealed type. Never remove its cover. If the cover is removed, Battery will become unusable.</li><li>• Battery may lose its usefulness if it is over discharged.</li><li>• If Battery is not to be used for a long period of time, remove it from the machine and charge it completely. Keep it in cool and dry place and charge it again monthly. Even though Battery is not used during storage, its capacity constantly decreases. Therefore its performance will decrease compared with the previous occasion the machine was used.</li></ul>

### 6:2 CHARGER

A special Battery Charger is used for STAIRMATE. Battery is automatically charged depending on battery discharge rate at a given time. This Battery

Charger is not equipped with a timer function. When battery reaches its fully charged level (Charger's Green LED will illuminate), Battery will continue to be charged with trickle current (0.1 to 0.2A). Be sure to disconnect Charger's Plug from Battery Pack after Green LED illuminates. (Charging Battery completely will take 8 hours.)

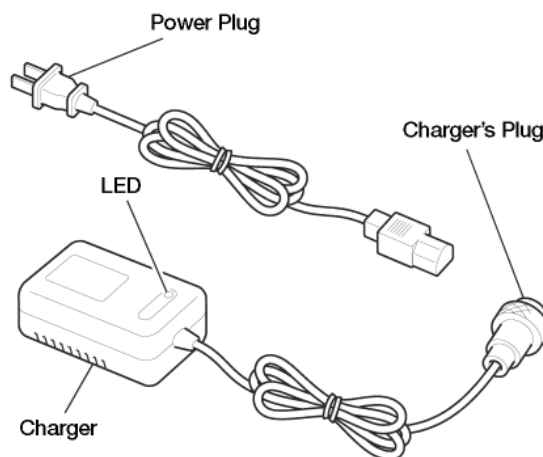

## 6.3 CHARGING PROCEDURE

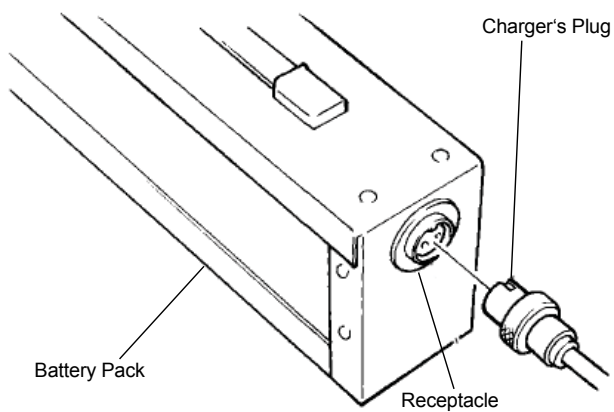
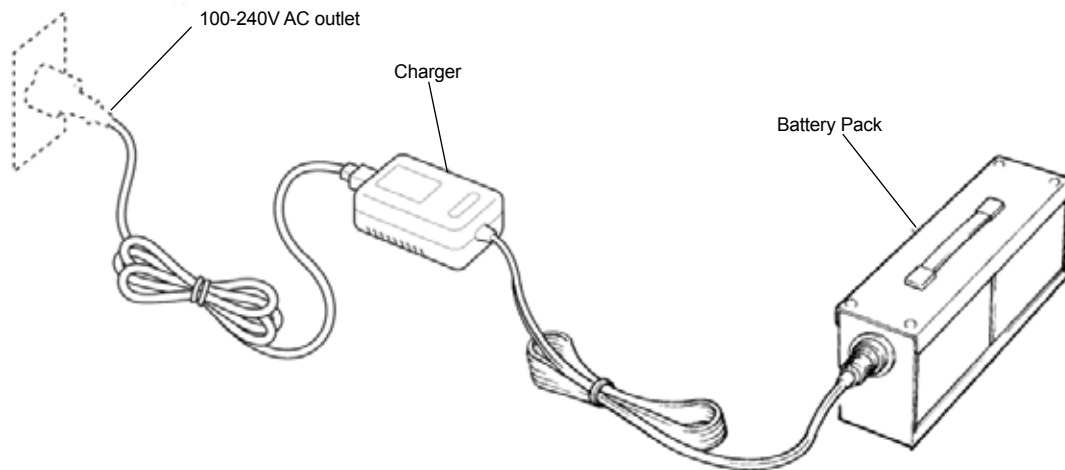

1. Connect Battery Charger's Plug to Battery Pack's Receptacle.

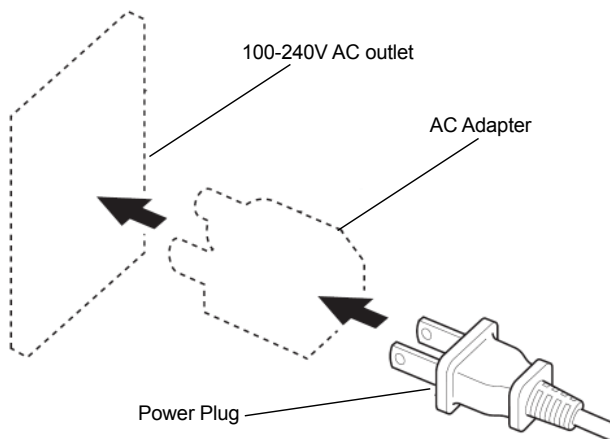

2. Connect AC Adapter to outlet (AC100 to 240V). Connect Power Plug.



**CAUTION**

Prepare an area-specific AC conversion Adapter for installation between AC outlet and Power Plug.



3. When Power Plug is inserted, the charging process immediately starts. The charging progress is indicated by LED's colors.

**Red** . . . Power is supplied.

**Orange** . Charging.

**Green** . . Fully charged.

NOTE: To confirm a fully charged Battery Pack, be sure to check it via Charger's full charge indication (green illuminated LED). Do not check via Battery Gauge indication. Battery Gauge indication does not accurately correspond to the actual battery capacity.

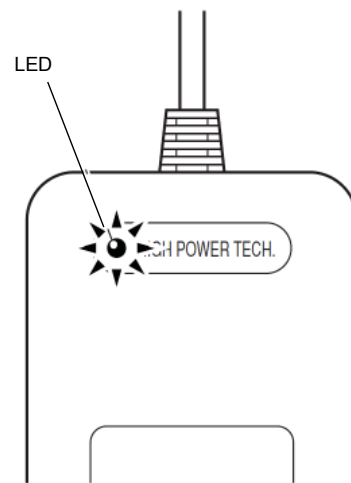

4. When charging is completed, disconnect Power Plug from the outlet and disconnect Charger's Plug from Battery Pack's Receptacle.



**CAUTION**

- This Charger is not equipped with a timer function. When Green LED illuminates, disconnect Charger's Plug from Battery Pack's Receptacle.
- Charge Battery in an ambient temperature between 5 and 40°C. If Battery is charged in an ambient temperature lower than 5°C, it may not charge fully.

## 6.4 MALFUNCTION, INSPECTION, RESOLUTION PROCEDURE

TROUBLE	CAUSE	COUNTERMEASURE
No power supplied. LED won't illuminate.	Insufficient insertion of Power Plug into outlet.	Check outlet and securely connect Power Plug.
	No power is supplied.	Check power and other relevant parts.
	Power Cord is broken.	Arrange its repair or replacement.
	Battery Charger's power source trouble	Arrange a check or repair.
	Receptacle and Plug are improperly connected.	Check the connecting parts and securely connect them.
	Battery Pack is improperly connected.	Check the connecting parts and securely connect them.
Green LED illuminates soon after the start of charging.	Battery is normally charged.	Normal.
	Battery malfunction.	Replace with a new Battery. (See P 17.)
The charging process is completed however work able period is shortened.	Battery nearly dead.	Replace with a new Battery. (See P 17.)
	Ambient temperature is low during charging.	Charge Battery in an ambient temperature between 5 and 40°C.

 <b>CAUTION</b>	<ul style="list-style-type: none"> <li>• For safe handling of Charger, be sure to read the instructions thoroughly before using Charger.</li> <li>• Charger is only to be used with an AC100-240V power source. Never connect Power Cable to any other power source specification.</li> <li>• Be sure to finish trickle charging within 12 hours after battery charging process is completed. Extended charging may reduce battery capacity resulting in shorter battery life.</li> <li>• Battery and Charger's Output Terminals have polarity. Confirm that those Terminals are correctly connected according their polarity. Improper connection will result in a short circuit and cause a cable to melt or other serious charger malfunction.</li> <li>• Never remove Charger Cover or you will risk receiving an electric shock.</li> <li>• Keep Charger indoors, away from direct sunlight and water splashes. Neglecting this can cause fire, electric shock or equipment malfunction.</li> <li>• As Battery deteriorates, its voltage will fail to reach normal full-charge voltage.</li> </ul>
--	---

## 6.5 BATTERY REPLACEMENT

1. Unscrew the screw mounting Battery Case and Cover.

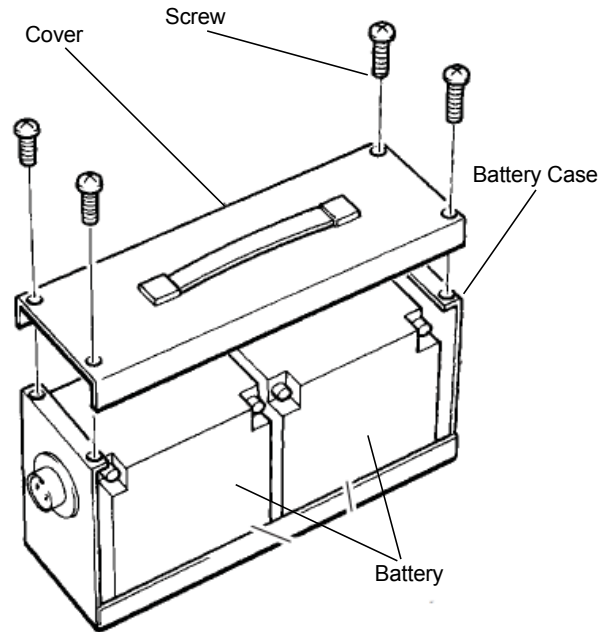

2. Disconnect cables from Battery Terminals, remove exhausted Batteries, and install new ones.
3. Connect cables to Battery Terminals as shown in the figure below. Confirm that cables are properly connected to proper terminals. Then apply adhesive agent to Connectors to prevent their loosening.

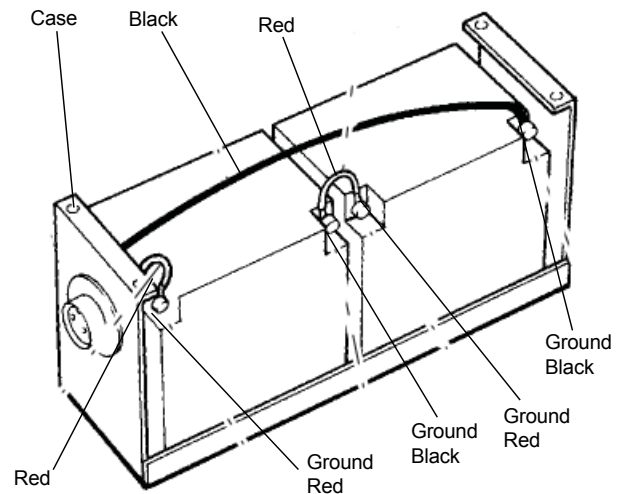

### CAUTION

While Key Switch is set to ON, power will be supplied from Battery. If STAIRMate is not be used, be sure to set Key to OFF and remove it from Key Switch.

Please regard to official rules and regulations for the disposal of batteries. Batteries are to be returned to sales operator or official public waste disposal site.

## 7. PRE-USE INSPECTION

## 7. PRE-USE INSPECTION

Before using the machine, be sure to carry out the daily inspection. The daily inspection will prevent trouble. It is essential before handling STAIRMATE.

### SWITCH INSPECTION

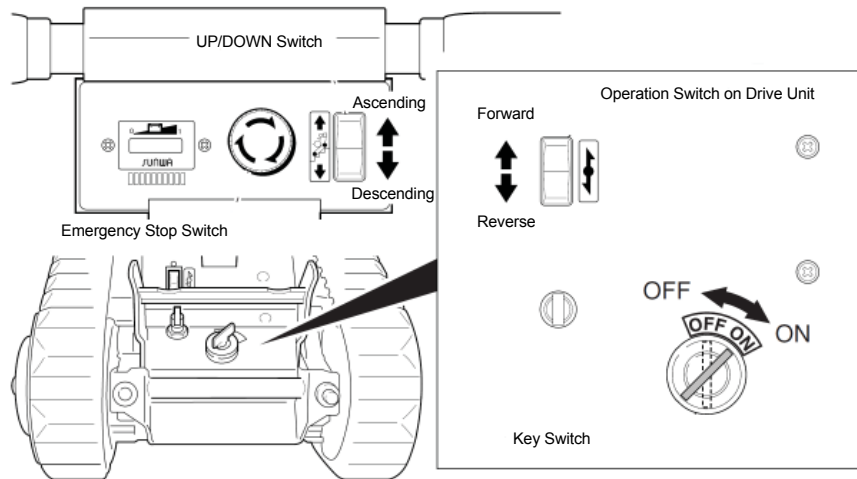

Check that all Switches function correctly.

### WHEELCHAIR MOUNT UNIT INSPECTION

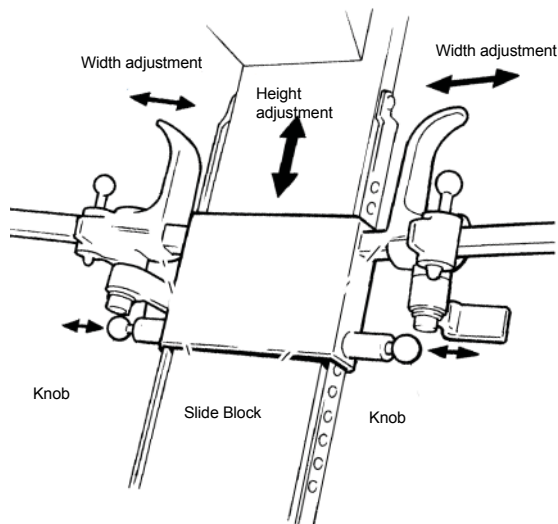

Check that there is no deformation or crack in Wheelchair Mount Unit and that it functions correctly.

### SEAT BELT INSPECTION

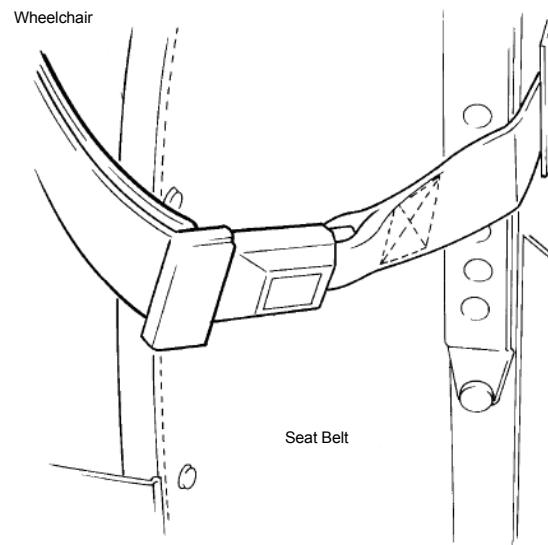

Check that there is no deformation or crack in any Seat Belt securing part and that Seat Belt is securely locked.

## PEDAL GUARD AND KICK BAR INSPECTION

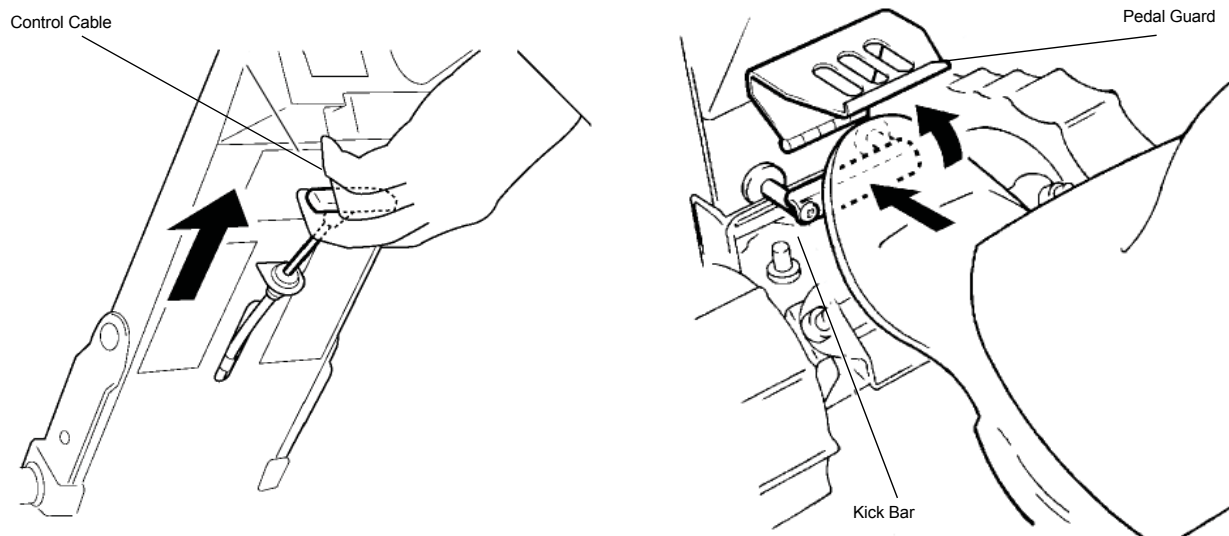

Check that there is no crack or other damage to Control Cable, Pedal Guard or Kick Bar and that they function normally.

## LOCK UNIT INSPECTION

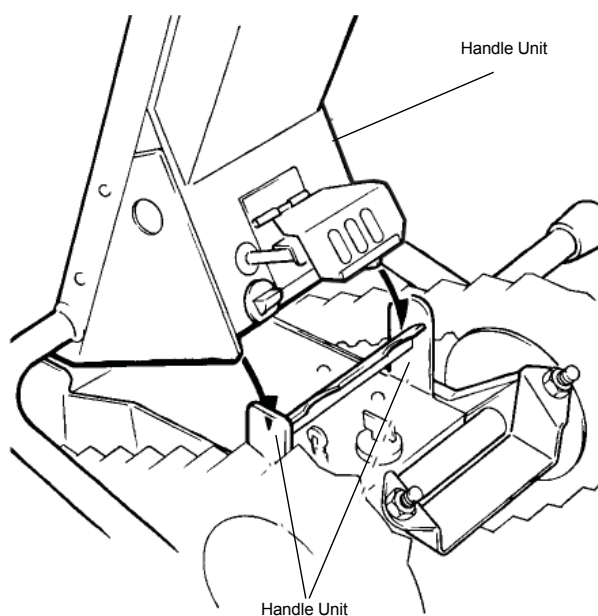

Check that Lock Unit functions correctly, and Handle Unit remains stowed when Handle is locked.

## MOTOR, REDUCTION GEAR INSPECTION

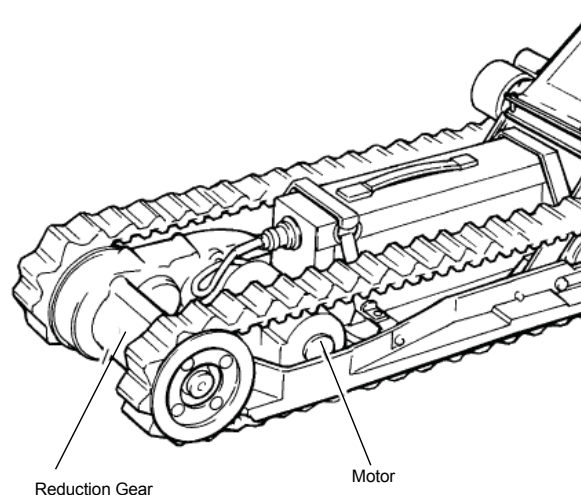

Check that Motor and Reduction Gear have no abnormal noise, deformation, crack or oil leakage.

## BATTERY GAUGE INSPECTION

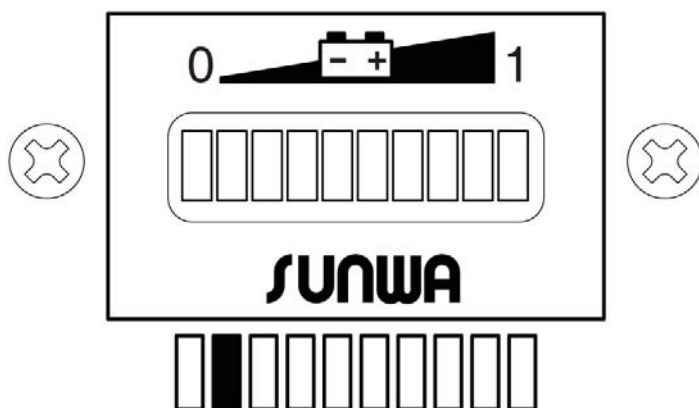





Check that the right end lamp of Battery Gauge is illuminated.

When the charge level decreases, the illuminating point will shift to the left.

If Battery Gauge is not illuminated at the right end, it means Battery is not fully charged or battery capacity is reduced due to its deterioration. The total running period will be diminished

## BATTERY GAUGE INDICATION

Battery Gauge	Available time (Charging percentage)
<b>1</b>  The right end LED illuminates	30 min. (100%)
<b>2</b>  The fourth LED from the right end illuminates	20 min. (65%) After operating, charge STAIRMATE's Battery Pack
<b>3</b>  The seventh LED from the right end illuminates	10 min. (30%)
<b>4</b>  The second LED from the left end flashes	Stopp (0%) Stop operating the machine and charge Battery immediately
<b>5</b>  The first and second LEDs from the left end flashes	This indication being prolonged will result in rapid Battery deterioration. Be sure to stop the machine at the „4“ indication and charge Battery.



### CAUTION

Any time Key Switch is set to ON, Battery Gauge indication may differ from its indication when the power was previously turned off.



## RUBBER CRAWLER INSPECTION

## SCREWS INSPECTION

Check that no Screw has dropped out and that all Screws are tightly attached.

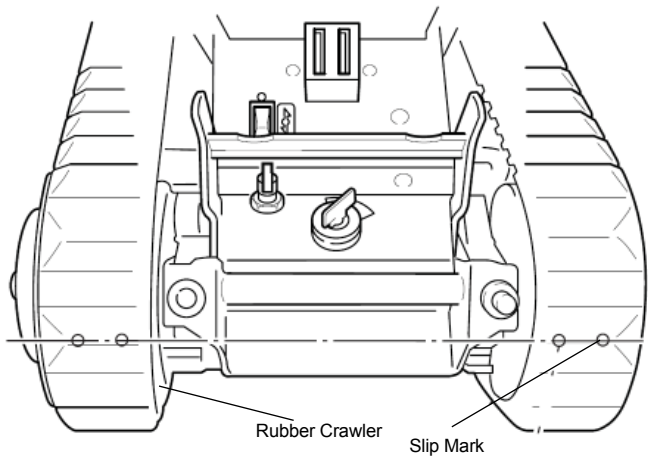

Check that there is no crack, wear or pitch error regarding Rubber Crawlers.

The pitch error can be confirmed from Slip Mark deviation.

## 8. OPERATION

## 8. OPERATION

### 8.1 WHEELCHAIR SETTING

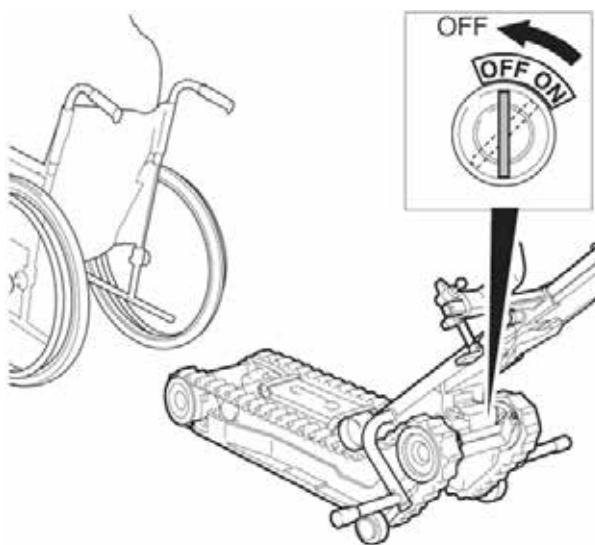

1. Confirm that Key Switch is set to „OFF“

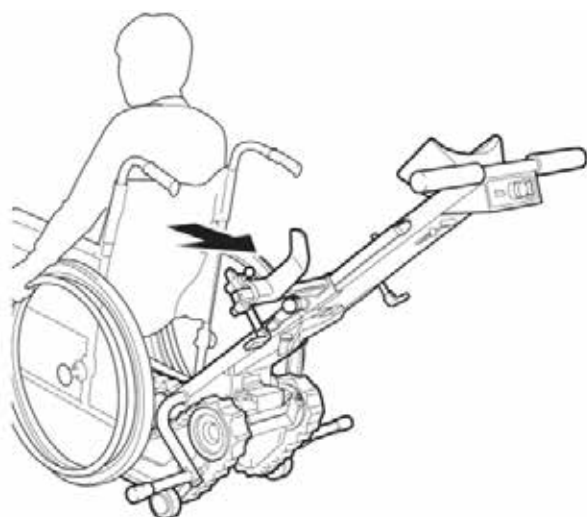

2. Set Wheelchair from the front of STAIRMATE.

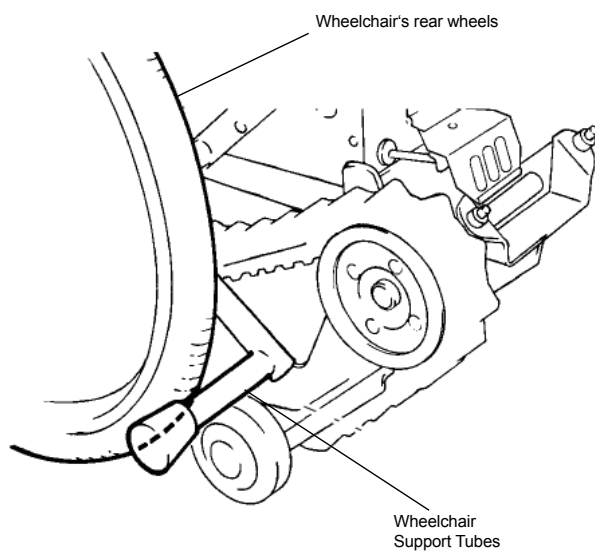

3. Move Wheelchair until Wheelchair's rear wheels lightly contact Wheelchair Support Tubes. Then set Wheelchair's parking brakes.

4. Pull Control Cable and raise Pedal Guard.  
Push Kick Bar with a toe and release Handle Lock.

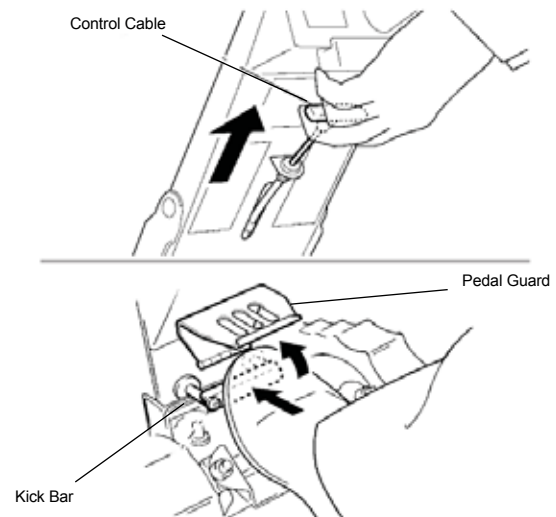

5. Raise Handle Unit until it lightly contacts Wheelchair.

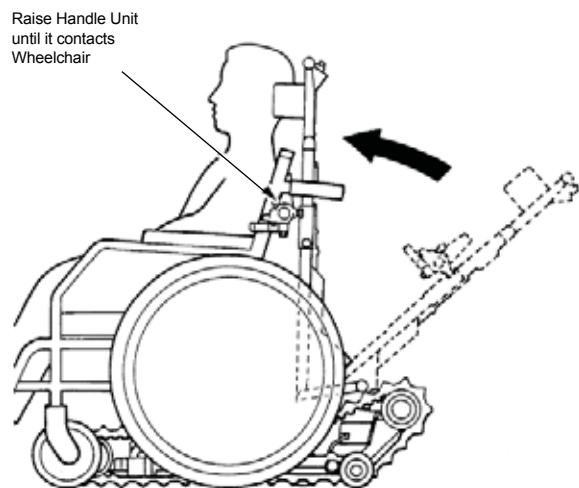

6. Slide each adjustable part of Wheelchair Mounting Unit until it contacts the inside of Wheelchair's handles.

- Vertical adjustment:  
Slide Wheelchair Mounting Unit vertically to its proper height by pulling Knob.
- Width adjustment:  
Adjust Slide Blocks laterally to secure Wheelchair's handles firmly.

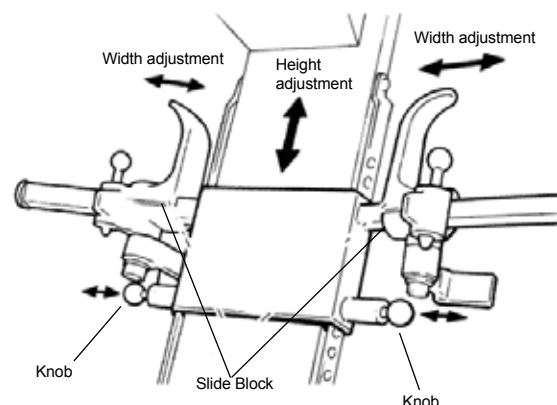

**CAUTION**

**CAUTION**

For Wheelchair handle width adjustment, set the right and left Slide Blocks to be equidistant from the center line of the machine.  
If Wheelchair mounting is off center, STAIRMATE's balance may be lost resulting in danger.

7. While pulling Stopper Pin, set Fork so that it secures Wheelchair's handle, and then the release Stopper Pin to lock Fork firmly.

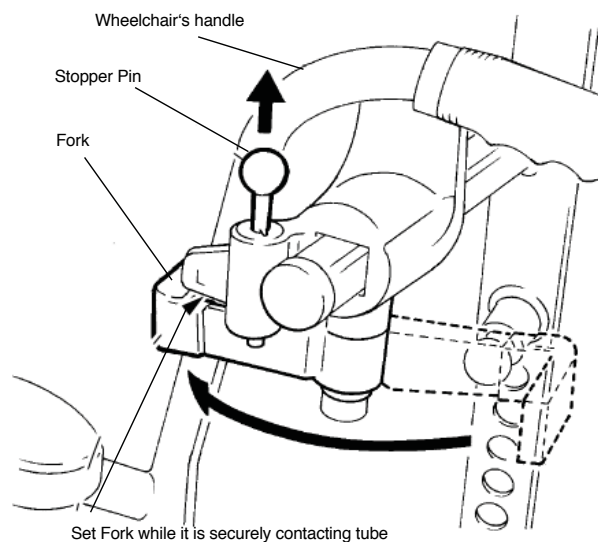
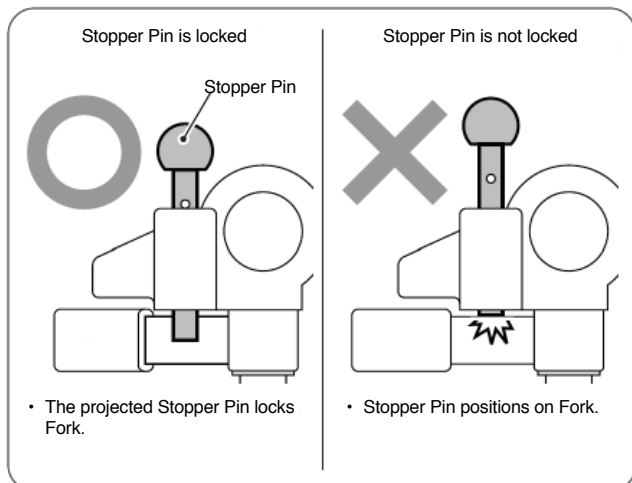

8. Adjust Seat Belt length to suit to the passenger. Securely fasten Seat Belt with Buckle. Confirm that Seat Belt is securely fastened.

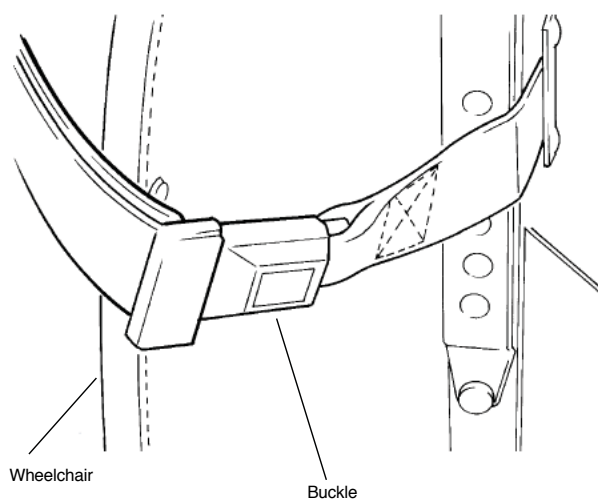

## WARNING

- Confirm that the tongue of Seat Belt and Buckle are completely latched.
- Ascending/Descending stair with unlatched Seat Belt is very dangerous. Never take a passenger in Wheelchair without fastening Seat Belt.

9. Set Key Switch to ON.

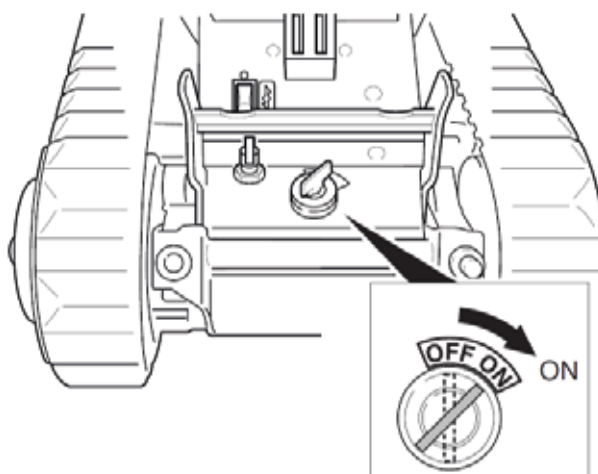

10. Pull down Handle Unit along its guide plate and lock it securely.

NOTE : Check that Battery Gauge shows Battery Pack charged enough. (Refer to P17 „Battery Gauge indication“) Unless Handle Unit is fully locked, Battery Gauge will not illuminate. (STAIRMate will not run even when Switch is pressed UP or DOWN.)

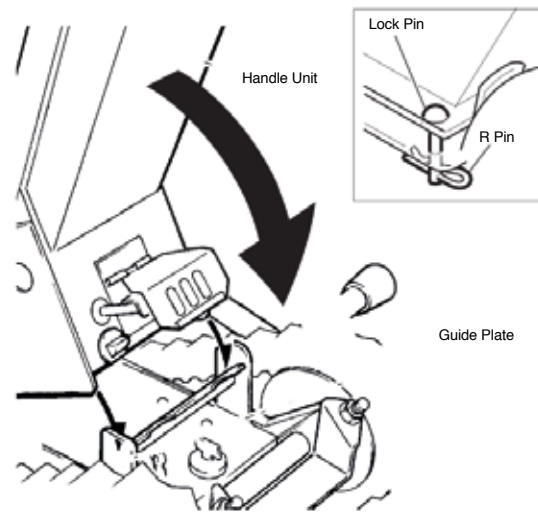

## CAUTION

Reconfirm that Lock Pins are installed to Handle's Hook Points and they are securely locked with their „R“ Pins. If Lock Pins are insecurely inserted, a serious accident such as passenger injury may occur.

11. To run STAIRMate on a flat floor surface, manually push/pull STAIRMate on its Wheels. Do not use its Rubber Crawlers. The operator must hold both Handle Grips and transfer Wheelchair using STAIRMate's Wheels while tilting STAIRMate to make its Wheels act as the fulcrum.

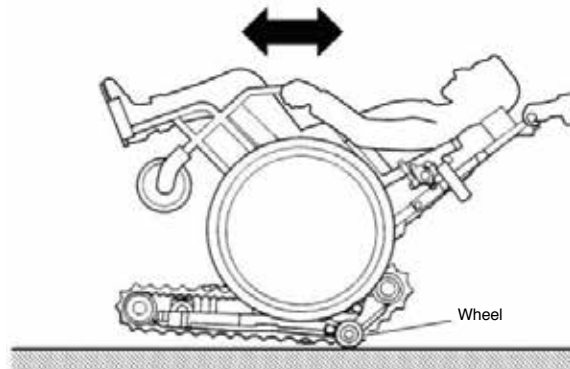

## WARNING

If operator releases Handle while Wheelchair is set on STAIRMate, STAIRMate may topple. To prevent a serious accident, operator must never release his/ her hands from STAIRMate's Handle.

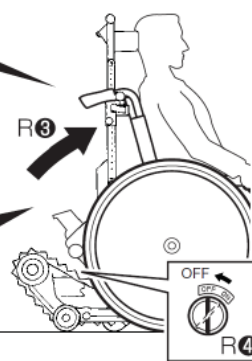
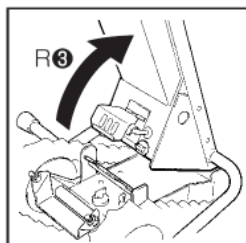
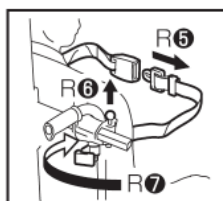
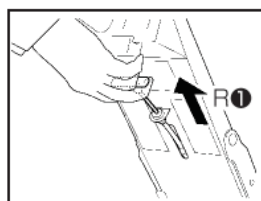

12. To release Wheelchair from STAIRMate, carry out with the reverse procedure of the attachment steps. (R ~R )

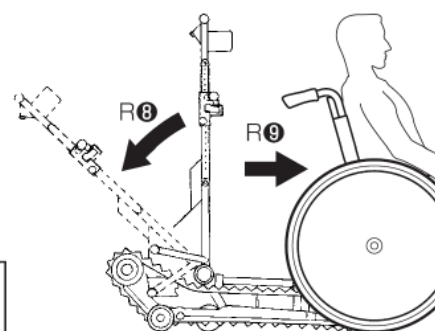

NOTE:

When STAIRMate is not in used, be sure to return Seat Belt to its original position on STAIRMate.

## 8.2 ASCENDING STAIRS

### 1. Position STAIRMATE at the stairs:

Position STAIRMATE at the base of the stairs, at a right angle (90°) to the stairway with the passenger's back towards the stairs.

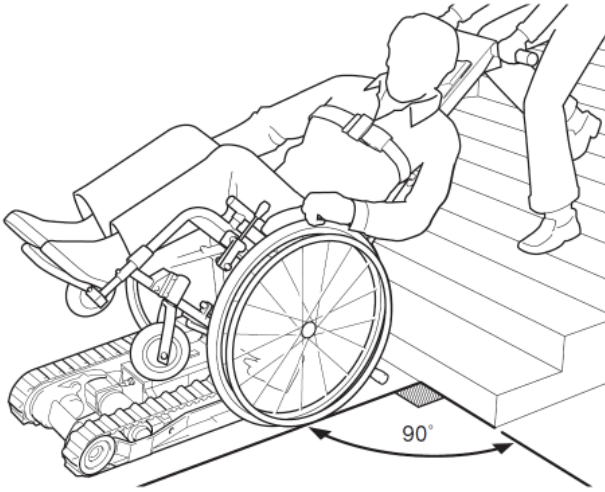

### CAUTION

- If STAIRMATE is run on the wooden stairs, some rubber marks may remain.
- If stair's slip preventing braid is loose, Rubber Crawlers may damage it further. Set STAIRMATE at a right angle (90°) to the stairs.

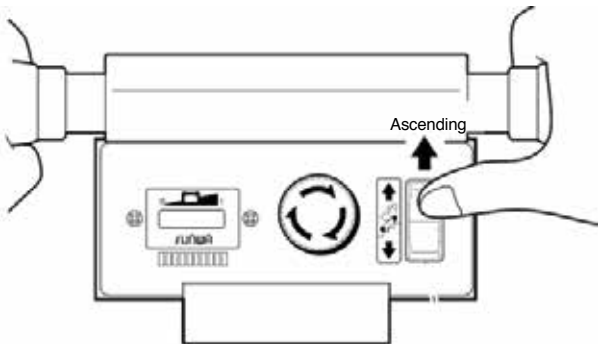

### 2. Start ascending:

Press the upper side of UP/DOWN Switch to ascend while supporting it to prevent STAIRMATE overturns on the stairs.

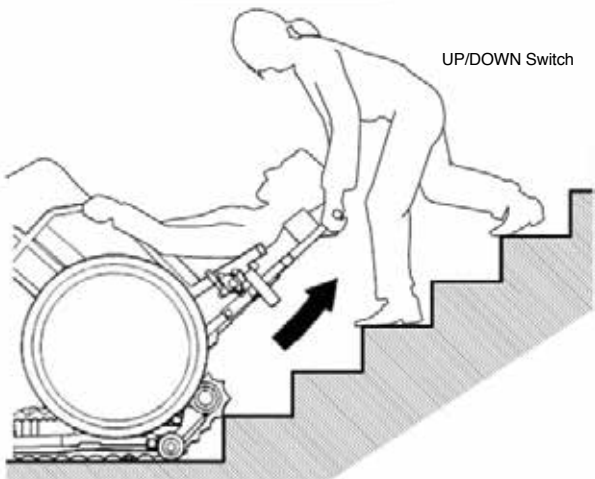

### WARNING

- If the lugs of the left and right Rubber Crawlers do not contact a stair noses at the same time, STAIRMATE will climb the stairs askew. This is a highly risky situation.
- The operator must hold Handle Grips with both hands the whole time STAIRMATE is on stairs or landings.
- While STAIRMATE runs on the stairs, the operator must be positioned upward of STAIRMATE. Improper supporting of STAIRMATE may cause a loss of balance and overturning or other serious accident.



3. Stopping STAIRMATE in the middle of the stairs Once the finger is released from Switch, Electromagnetic Brake will function immediately and STAIRMATE will immediately stop. Because the lugs rest on the stair noses, STAIRMATE will not slide down the stairs.

Stable  
(Contacting three stair noses)

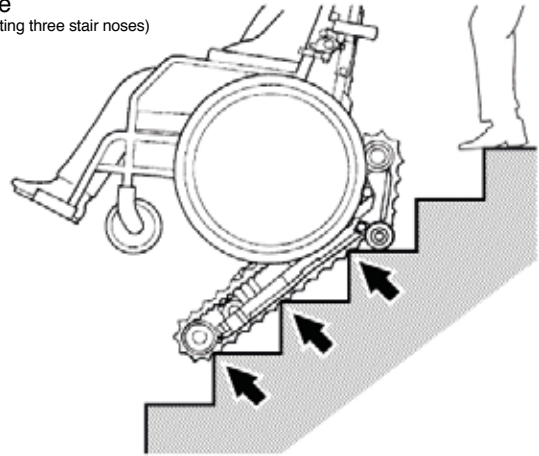

Caution  
(Contacting only two stair noses)

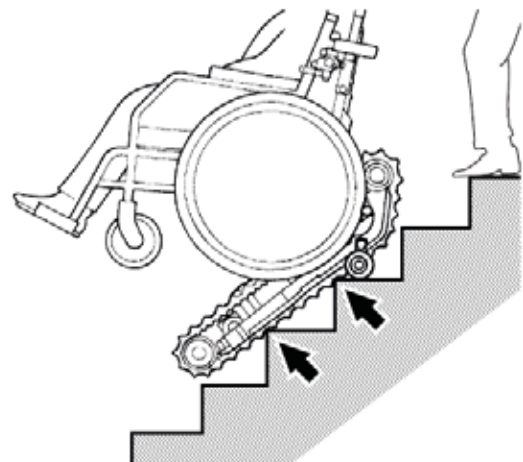

## CAUTION

Avoid STAIRMATE stopping midway on the stairs.  
If STAIRMATE must stop midway on the stairs, the operator must stay with STAIRMATE holding STAIRMATE with both hands.



## WARNING

Keep Rubber Crawler contact points as broad as possible.  
Contacting with 2 stair noses is more dangerous than contacting with 3 stair noses.

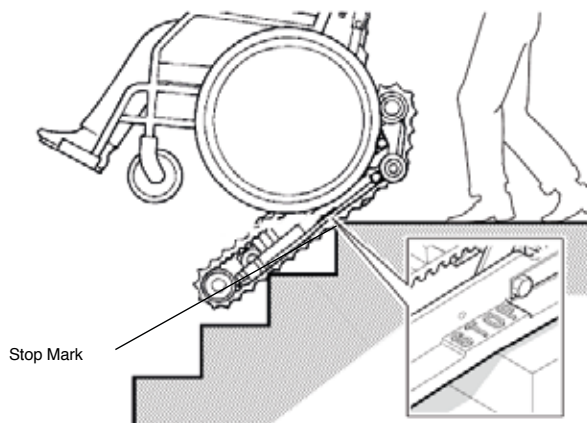

4. STAIRMATE reaches the top of the stairs:
1. When STAIRMATE reaches a landing or, the top of the stairs, be sure to stop STAIRMATE for a moment when Stop Mark is just on the edge of top stair.

**NOTE:** Stop Mark is only an approximate point. The stop position will vary according to the passenger's dimensions.



## WARNING

If STAIRMATE is not stopped at its stop position and UP Switch is kept pressed, STAIRMATE will suddenly fall down backward. This will be dangerous.

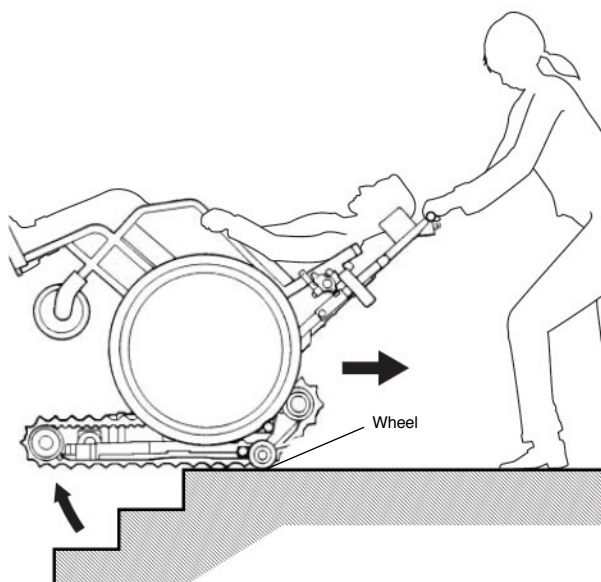

2. After STAIRMATE is temporarily stopped, pull Handle slowly toward the operator. STAIRMATE's Wheels will contact the floor. After Wheels' contact is confirmed, press UP Switch again to move STAIRMATE to a safe, flat area.



## CAUTION

Because Operation Switches are positioned behind the passenger and the operator controls STAIRMATE from the rear of the passenger, an unaccustomed passenger may feel anxiety. As the operator operates STAIRMATE, he/she must describe the operation in a clear voice at the following times :

1. Before attaching or releasing Wheelchair to/from STAIRMATE.
2. Before pressing UP Switch.
3. Before STAIRMATE starts ascending the stairs.
4. Before tilting STAIRMATE to bring its Wheels to the floor after it reaches its Stop Mark.
5. Before changing STAIRMATE's direction.

## 8.3 DESCENDING STAIRS

### 1. Start descending:

Position STAIRMATE at the top of the stairs, at a right angle (90°) to the stairway with the passenger facing toward the stairs.

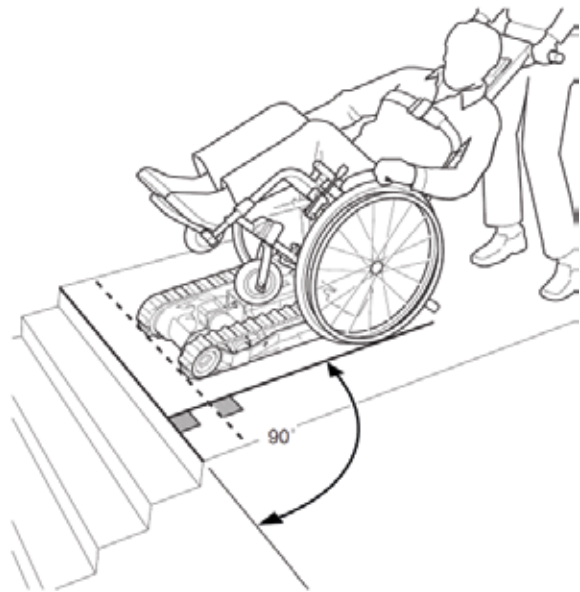

### 2. Press the lower side of UP/DOWN Switch to set STAIRMATE. When STAIRMATE's Stop Mark reaches the top edge of the stairs, be sure to stop STAIRMATE for a moment.

**NOTE:** Stop Mark is only an approximate point. The stop position will vary according to the passenger's dimensions.

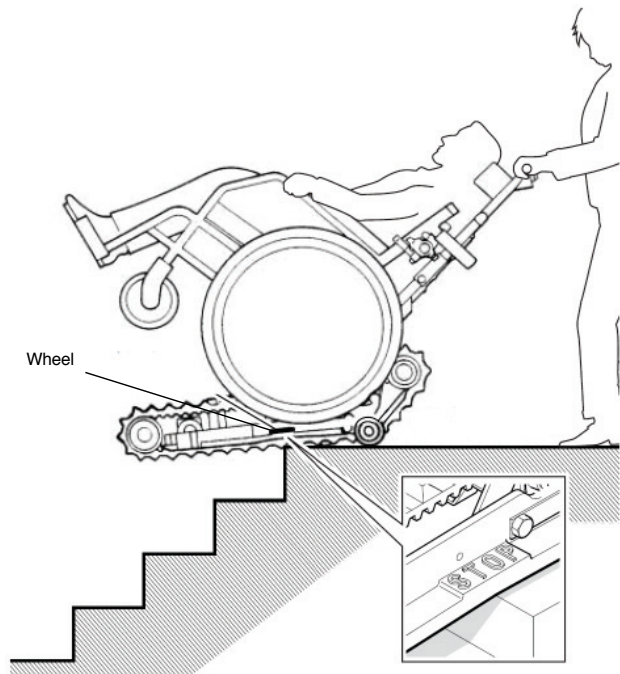

### CAUTION

- If STAIRMATE is run on the wooden stairs, some rubber marks may remain.
- If stair's slip preventing braid is loose, Rubber Crawlers may damage it further.



### WARNING

- If the lugs of the left and right Rubber Crawlers do not contact a stair nose at the same time, STAIRMATE will descend the stairs askew. This is a highly risky situation.
- If STAIRMATE is not stopped at its stop position and DOWN Switch is kept pressed, STAIRMATE will suddenly fall down forward. This will be dangerous.
- The operator must hold Handle Grips with both hands the whole time STAIRMATE is on stairs or landings.

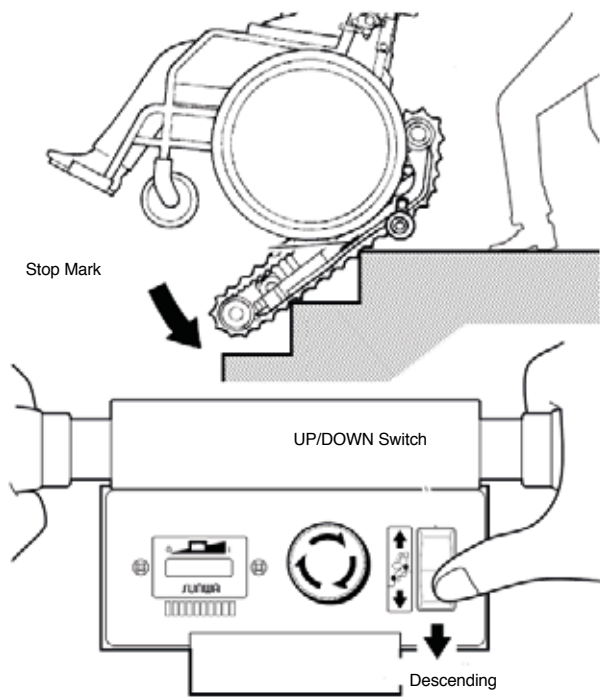

3. Slowly push Handle until Rubber Crawlers contact the second stair while keeping STAIRMATE balanced at the same position.

4. When Rubber Crawlers contact the lower stair and STAIRMATE becomes stable, press DOWN Switch



## WARNING

While STAIRMATE runs on the stairs, the operator must be positioned upward of STAIRMATE. Improper supporting of STAIRMATE may cause a loss of balance and overturning or other serious accident.

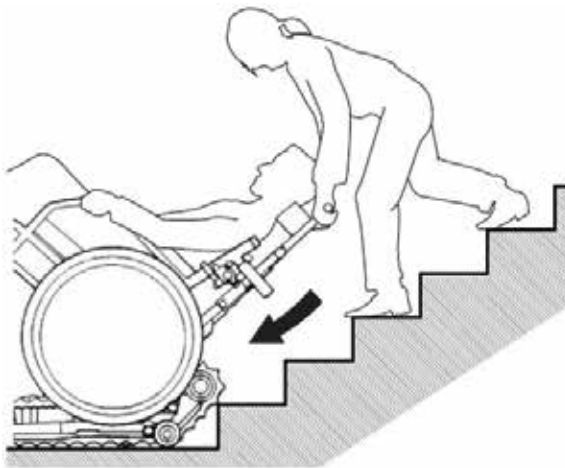

5. STAIRMATE reaches the bottom of the stairs Keep pressing DOWN Switch until STAIRMATE reaches the bottom of the stairs. STAIRMATE will automatically transfer to horizontal running. Release DOWN Switch and Wheel STAIRMATE to a safe area.



## CAUTION

Because Operation Switches are positioned behind the passenger and the operator controls STAIRMATE from the rear of the passenger, an unaccustomed passenger may feel anxiety. As the operator operates STAIRMATE, he/she must describe the operation in a clear voice at the following times :

1. Before attaching or releasing Wheelchair to/from STAIRMATE.
2. Before pressing DOWN Switch.
3. Before STAIRMATE starts descending the stairs.
4. Before tilting STAIRMATE to bring its Wheels to the floor after it reaches its Stop Mark.
5. Before changing STAIRMATE's direction.

## 9. DAILY MAINTENANCE AND CARE

## 9. DAILY MAINTENANCE AND CARE

### 9.1 BATTERY

- When STAIRMATE is not to be used or its Battery Pack is to be charged, turn off Key Switch and remove Key. If Key Switch is kept in the ON position, Battery will quickly discharge and it may not have capacity to run STAIRMATE the following day.
- After the end of operation or before storing it, be sure to charge Battery using special Charger. (Because it requires a long charging time, if it is not charged enough, it will be difficult to operate the following day.)
- When storing STAIRMATE for a long period of time, maintain its Battery in a fully charged state. Not doing so will result in an extremely short life. (Even if Battery is already fully charged, recharge Battery again monthly.)

### 9.2 RUBBER CRAWLERS

- If oil adheres, immediately wipe it off completely.
- Check there is no crack or wear concerning Rubber Crawlers. If any defect on Rubber Crawler is observed, stop STAIRMATE immediately and replace the part with a new one.

### 9.3 MISCELLANEOUS

- Clean frame sections with a brush.
- Clean hand grips with a commercially available spray disinfectant.

## 10. TERMS OF GUARANTEE

## 10. TERMS OF GUARANTEE

The activated guarantee is for a period of five years, apart from batteries and rubber parts. It is limited to complaint parts free of charge excluding freight, cost for labor or travelling expenses.

We suggest to make maintenance once a year by authorized agent to avoid guarantee obligations.

# 11. INSPECTION AND MAINTENANCE

It is important that the unit keep a good condition through the following check items on daily basis. Neglecting this procedure may cause an accident or may shorten the life of unit.

- Required checking before operation.

No.	CHECK ITEM	WHAT SHOULD BE CHECKED	FREQUENCY	REMARK
1	Key Switch and Battery's remaining capacity	When the Key Switch is turned on, each switch and button work correctly. Battery Gauge shows enough capacity to operate the unit. When the Key Switch is turned off, each switch and button do not work.	each time.	
2	UP / DOWN Switch	After turning on the Key Switch, press and hold UP or DOWN side, the Rubber Crawlers run correctly in each direction. Releasing the switch, the Rubber Crawlers stop immediately.	each time.	
3	Emergency Stop Button	During the procedure No.2, pressing the button, the Rubber Crawlers stop immediately.	each time.	
4	Abnormal noise from running Rubber Crawler	During the procedure No.2, any abnormal noise is not from running Rubber Crawlers.	each time..	
5	Rubber Crawlers' condition	No looseness is in tension of the Rubber Crawler. And no wrong alignment is between left and right. No lacking of outer lug is on the surface.	each time..	
6	Sprocket, Idler Wheel and Side Ring	No deforming is found.	monthly	
7	Rubber Wheels	Excessive wearing or damage. The Wheel Bracket has a smooth motion in upward/downward.	each time.	
8	Locking up / Release the Handle Unit	The Handle Unit is securely locked up on or released from the Drive Unit. The Pedal Guard can be smoothly opened to push the Kick Bar forward. The Kick Bar can be pushed smoothly forward.	each time.	
9	Wheelchair Mount Unit	The Slide Arm smoothly moves vertically. The Slide Blocks smoothly moves on the Slide Arms. The Stopper Pins lock the Forks.	each time.	
10	Seat Belt	The Seat Belt is fastened securely.	each time.	
11	Battery	No stain due to battery's leakage or no corrosion are on the Battery Case.	monthly	

- Required check after the operation

No.	CHECK ITEM	WHAT SHOULD BE CHECKED	FREQUENCY	REMARK
1	Battery's remaining capacity	LED indicator on the Battery Gauge has moved after the operation? In case that the LED indicator moved into one position or more, charge the Battery in no time.	each time.	Whenever it's necessary.
2	Exterior	Any deformed part on the exterior?	each time.	
3	Charging	Any damage is on the wire or the plug of charger?	monthly	
		The power switch of charger functions correctly? The charging procedure does not have any problem?	each time.	



## 12. REUTILISATION

measures are no longer applicable or other regulations apply. Clean and disinfect the unit in accordance with Point 9 prior to reutilisation. An inspection must be carried out by an authorised dealer prior to reutilisation.

# 13. DEALER

## Austria/Czech

Lehner Lifttechnik GmbH Salling 8  
4724 Neukirchen am Walde  
Phone: +43 7278 3514  
Fax: +43 7278 3514-12  
office@lehnerlifttechnik.at  
www.lehner-lifttechnik.at

## Belgium

Metra bv  
Jan Samijnstraat 25  
9050 Gent  
Phone: +32 9227 7174  
Fax: +32 9227 0280  
info@metra.be  
www.metra.be

## Bulgaria

Pro-Lift Bulgaria Ltd.  
Krasno Selo 191  
1612 Sofia  
Phone: +359 886 097189  
office@pro-lift.eu  
www.pro-lift.eu

## Denmark

Trappetjeneren ApS  
Arnold Nielsens Boulevard 64A  
2650 Hvidovre  
Phone: +45 31 728500  
Fax: +45 70 141206  
mail@trappetjeneren.dk  
www.trappetjeneren.dk

## Finland

Apuväline Lähdemäki Oy  
Simakankatu 11  
30420 Forssa  
Phone: +358 400 483258  
Fax: +358 342 40699  
sales@apuvahlinelahde.fi  
www.apuvahlinelahde.fi

## France

Reha-Trans  
4 Rue des Forgerons  
68600 Wolfgantzen  
Phone: +33 389 791777  
Fax: +33 389 791924  
info@reha-trans.fr  
www.reha-trans.fr

## Germany

SOBRATEC GmbH  
Schluckenauer Straße 11a  
02689 Sohland/Spree  
Phone: +49 35936 45981  
Fax: +49 35936 30982  
info@sobratec-treppenlifte.de  
www.sobratec-treppenlifte.de

## Germany

ANGO Reha Technik Vertriebs GmbH  
Stemeler Strasse 99  
59846 Sundern  
Phone: +49 2933 9218800  
Fax: +49 2933 9218809  
info@ango-reha.de  
www.ango-reha.de

## Germany

Perfekta-Lift GmbH  
Glehner Heide 1  
41352 Korschenbroich  
Phone: +49 2182 886060  
Fax: +49 2182 8860610  
info@perfekta-lift.de  
www.perfekta-lift.de

## Germany

Prüfer & Co. Aufzugbau GmbH  
Ruhlaer Straße 9  
14199 Berlin  
Phone: +49 30 8264838  
Fax: +49 30 8266469  
info@pruefer-aufzugbau.de  
www.pruefer-aufzugbau.de

## Germany

Süddeutsche Sanilift GmbH  
Pflasterackerstr. 60  
70186 Stuttgart  
Phone: +49 711 51865275  
Fax: +49 711 51865278  
info@sanilift.de  
www.sanilift.de

## Germany

Strehlow GmbH  
Havelstraße 23  
39126 Magdeburg  
Phone: +49 391 505660  
info@strehlow.info  
www.strehlow.info

## Greece

Konstantinos Dederis  
62 Argiroupoleos  
16451 Athen  
Phone: +30 2105443894  
Mobil: +30 6948245364  
kdederis@yahoo.gr  
www.dederis-orthopedika.gr

## Hungary

Aluhit KFT  
Uttörö u. 20  
2510 Dorog  
Phone: +36 209224777  
Fax: +36 633502791  
info@aluhit.hu  
www.aluhit.hu

## Hungary

Nyír-Lift Kft  
Debreceni út 236  
4400 Nyíregyháza  
Phone: +36 30 6773070  
Fax: +36 42 490454  
info@nyirlift.hu  
www.nyirlift.hu

## Israel

Galim Import & Marketing Ltd.  
Mosav Amatz  
Shnei Alonim 1  
38870 Omets  
Phone: +972 72 2116000  
Fax: +972 72 2507879  
galimimport@gmail.com  
www.galimimport.com

## Latvia

Elevet SIA  
Vestienas street 20  
LV 1035 Riga  
Phone: +371 25708022  
Fax: +371 67574023  
elevet@elevet.lv  
www.elevet.lv

## Netherlands

Escape Mobility  
Bochholtzerweg 14 c  
6369 TG Simpelveld  
Phone: +31 455280670  
info@escape-mobility.com  
www.escape-mobility.com

## Netherlands

Evacuatieexpert  
Sloetsweg 5  
7557 HS Hengelo  
Phone: +31 748539984  
info@evacuatieexpert.nl  
www.evacuatieexpert.nl

## Poland

Horyzonty bez Granic  
Aneta Angowska  
ul. F. Fenikowskiego 7A/35  
84-240 Reda  
Phone: +48 501 422992  
biuro@horyzontybezgranic.pl  
www.horyzontybezgranic.pl

## Poland

Haltia Rehabilitacja & Ortopedia  
ul. Paprotna 8  
51-117 Wrocław  
Phone: +48 71 3528415  
Fax: +48 68 4124206  
info@haltia.pl  
www.haltia.pl

## Poland

Reha Bloch  
ul. Lermontowa 3  
60-461 Poznań  
Phone: +48 61 8423546  
Fax: +48 61 8423546  
biuro@rehabloch.pl  
www.rehabloch.pl

## Portugal

WELL4ALL Iberica  
Rua Major Joao Luis de Moura  
Famoes Park, Armazem W1685-253  
Famoes - Lisboa  
Phone: +351 1 219 349496  
Fax: +351 1 219 330188  
alice.rosa@well4alliberica.pt  
www.well4alliberica.pt

## Russia

CTAPR Drushby Str. 34  
241030 Bryansk  
Phone: +7 4832 321132  
info@ctapr.ru  
www.ctapr.ru

**Slovenia**

JR Product d.o.o. Stegne 7  
1000 Ljubljana  
Phone: +386 1511 4482  
Fax: +386 1511 4483  
info@jr-product.si  
www.jr-product.si

**Spain**

Stannah Incisa S.L.U.  
c/ Eduard Marquina 26  
08911 Badalona  
Phone: +34 93 4646770  
Fax: +34 93 3891534  
otecnica@stannah.es  
www.stannah.es

**Spain**

Enier  
Av. De Franca 205  
17840 Sarrià de Ter  
Phone: +34 972 171374  
Fax: +34 972 170678  
enier@enier.com  
www.enier.com

**Switzerland**

BACO Service AG  
Glättemühleweg 22  
3613 Steffisburg  
Phone: +41 33 4394141  
Fax: +41 33 4394142  
bern@hoeggli.ch  
www.baco-ag.ch

**Switzerland**

Garaventa Liftech AG  
Fännring 2  
6403 Küssnacht am Rigi  
Phone: +41 41 8547880  
info@garaventalift.ch  
www.garaventalift.ch

**Switzerland**

Rigert AG Treppenlifte  
Fännring 2  
6403 Küssnacht am Rigi  
Phone: +41 41 8542010  
info@rigert.ch  
www.rigert.ch

**United Kingdom**

Evaccess  
Swallow Evacuation and Mobility  
Products Limited  
197 Vicarage Road,  
Kings Heath B14 7QQ  
Birmingham  
Phone: +44 121 4443690  
info@evaccess.uk  
www.evaccess.uk



M. BARTELS  
REHA IM- & EXPORT GMBH



M. BARTELS  
Reha Im - & Export GmbH  
Fangdieckstr. 68  
22547 Hamburg

Tel. +49 (0) 40 | 54 75 33 33  
[m.bartels@reha-europe.com](mailto:m.bartels@reha-europe.com)  
[www.reha-europe.com](http://www.reha-europe.com)

Presented by:

--